

|      |         |             |       |       |      |
|------|---------|-------------|-------|-------|------|
| REV. | ECN NO. | DESCRIPTION | MDF'D | APP'D | DATE |
|      |         |             |       |       |      |
| REV. |         |             |       |       |      |
|      |         |             |       |       |      |

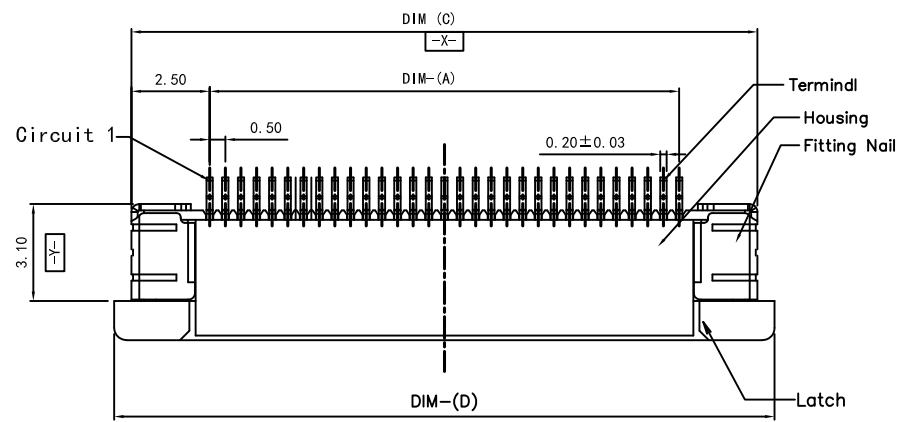

- Note:
- Material:
    - Housing: thermoplastic high temp.UL94V-0; Color: natur
    - Latch: thermoplastic high temp.UL94V-0; Color: black.
    - Terminal: copper alloy.
    - Fitting Nail: copper alloy.
  - Finish:
    - Terminal: Underplating: Au/matt Tin overall.
    - Fitting Nail: Underplating: matt Tin overall.
  - Product must comply HF RoHS specification.
  - Product No:

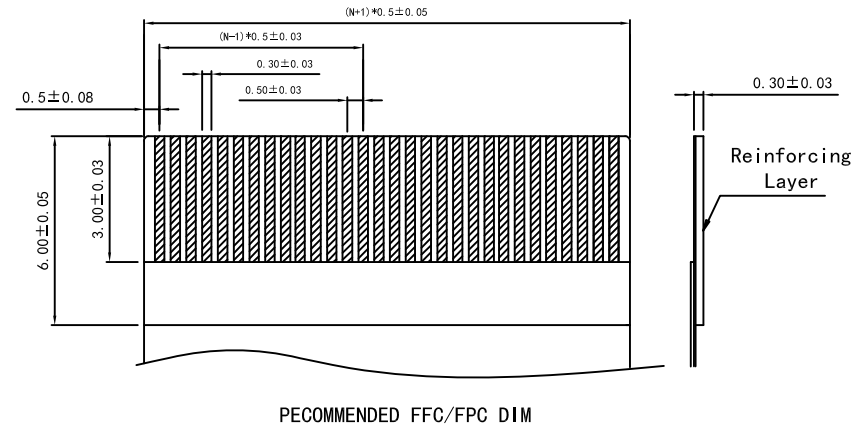
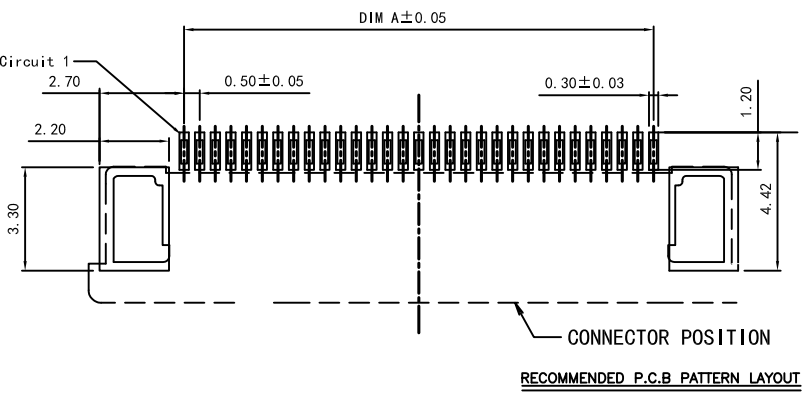
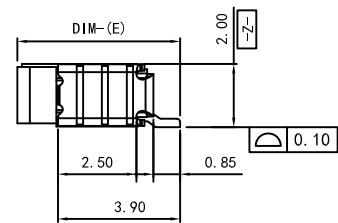
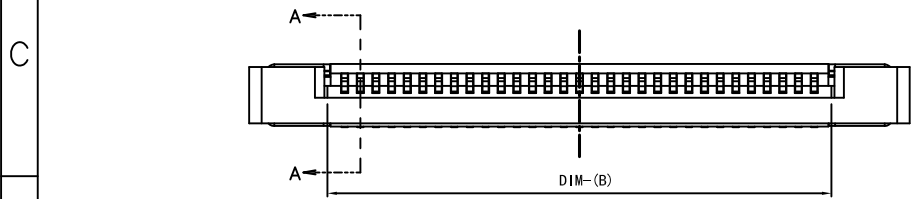

| SIZE | DIM-A | DIM-B | DIM-C | DIM-D | DIM-E | DIM-F |
|------|-------|-------|-------|-------|-------|-------|
| 4P   | 1.50  | 2.60  | 6.50  | 7.60  |       |       |
| 5P   | 2.00  | 3.10  | 7.00  | 8.10  |       |       |
| 6P   | 2.50  | 3.60  | 7.50  | 8.60  |       |       |
| 7P   | 3.00  | 4.10  | 8.00  | 9.10  |       |       |
| 8P   | 3.50  | 4.60  | 8.50  | 9.60  |       |       |
| 9P   | 4.00  | 5.10  | 9.00  | 10.10 |       |       |
| 10P  | 4.50  | 5.60  | 9.50  | 10.60 |       |       |
| 11P  | 5.00  | 6.10  | 10.00 | 11.10 |       |       |
| 12P  | 5.50  | 6.60  | 10.50 | 11.60 |       |       |
| 13P  | 6.00  | 7.10  | 11.00 | 12.10 |       |       |
| 14P  | 6.50  | 7.60  | 11.50 | 12.60 |       |       |
| 15P  | 7.00  | 8.10  | 12.00 | 13.10 |       |       |
| 16P  | 7.50  | 8.60  | 12.50 | 13.60 |       |       |
| 17P  | 8.00  | 9.10  | 13.00 | 14.10 | 5.20  | 6.45  |
| 18P  | 8.50  | 9.60  | 13.50 | 14.60 |       |       |
| 19P  | 9.00  | 10.10 | 14.00 | 15.10 |       |       |
| 20P  | 9.50  | 10.60 | 14.50 | 15.60 |       |       |
| 21P  | 10.00 | 11.10 | 15.00 | 16.10 |       |       |
| 22P  | 10.50 | 11.60 | 15.50 | 16.60 |       |       |
| 23P  | 11.00 | 12.10 | 16.00 | 17.10 |       |       |
| 24P  | 11.50 | 12.60 | 16.50 | 17.60 |       |       |
| 25P  | 12.00 | 13.10 | 17.00 | 18.10 |       |       |
| 26P  | 12.50 | 13.60 | 17.50 | 18.60 |       |       |
| 27P  | 13.00 | 14.10 | 18.00 | 19.10 |       |       |
| 28P  | 13.50 | 14.60 | 18.50 | 19.60 |       |       |
| 29P  | 14.00 | 15.10 | 19.00 | 20.10 |       |       |
| 30P  | 14.50 | 15.60 | 19.50 | 20.60 |       |       |
| 31P  | 15.00 | 16.10 | 20.00 | 21.10 |       |       |
| 32P  | 15.50 | 16.60 | 20.50 | 21.60 |       |       |
| 33P  | 16.00 | 17.10 | 21.00 | 22.10 |       |       |
| 34P  | 16.50 | 17.60 | 21.50 | 22.60 |       |       |
| 35P  | 17.00 | 18.10 | 22.00 | 23.10 |       |       |
| 36P  | 17.50 | 18.60 | 22.50 | 23.60 |       |       |
| 37P  | 18.00 | 19.10 | 23.00 | 24.10 |       |       |
| 38P  | 18.50 | 19.60 | 23.50 | 24.60 |       |       |
| 39P  | 19.00 | 20.10 | 24.00 | 25.10 |       |       |
| 40P  | 19.50 | 20.60 | 24.50 | 25.60 |       |       |
| 41P  | 20.00 | 21.10 | 25.00 | 26.10 |       |       |
| 42P  | 20.50 | 21.60 | 25.50 | 26.60 |       |       |
| 43P  | 21.00 | 22.10 | 26.00 | 27.10 |       |       |
| 44P  | 21.50 | 22.60 | 26.50 | 27.60 |       |       |
| 45P  | 22.00 | 23.10 | 27.00 | 28.10 |       |       |
| 46P  | 22.50 | 23.60 | 27.50 | 28.60 |       |       |
| 47P  | 23.00 | 24.10 | 28.00 | 29.10 |       |       |
| 48P  | 23.50 | 24.60 | 28.50 | 29.60 | 5.75  | 7.00  |
| 49P  | 24.00 | 25.10 | 29.00 | 30.10 |       |       |
| 50P  | 24.50 | 25.60 | 29.50 | 30.60 |       |       |
| 51P  | 25.00 | 26.10 | 30.00 | 31.10 |       |       |
| 52P  | 25.50 | 26.60 | 30.50 | 31.60 |       |       |
| 53P  | 26.00 | 27.10 | 31.00 | 32.10 |       |       |
| 54P  | 26.50 | 27.60 | 31.50 | 32.60 |       |       |
| 55P  | 27.00 | 28.10 | 32.00 | 33.10 |       |       |
| 56P  | 27.50 | 28.60 | 32.50 | 33.60 |       |       |
| 57P  | 28.00 | 29.10 | 33.00 | 34.10 |       |       |
| 58P  | 28.50 | 29.60 | 33.50 | 34.60 |       |       |
| 59P  | 29.00 | 30.10 | 34.00 | 35.10 |       |       |
| 60P  | 29.50 | 30.60 | 34.50 | 35.60 |       |       |

ROLLUP DIRECTION AFTER PLATING

|  |                        |                                  |                          |
|--|------------------------|----------------------------------|--------------------------|
| Unit : mm                              | PROJECTION             | 东莞市高钺达电子科技有限公司<br>惠州市高钺达光电科技有限公司 |                          |
| GENERAL TOLERANCES: (UNLESS SPECIFIED) | D.R. 15/04/2022<br>李小学 | 0.5Pitch H=2.0 FPC 插拔上接          | PD./FILE NO. &PRODUCT_NO |
| 0 = ±.20                               | CH.K                   | CONN.Lower single terminal       | C20C0014A                |
| 0.0 = ±.10                             | APV.D                  | SCALE 1:1                        | REV. 01                  |
| 0.00 = ±.05                            |                        | SIZE A4                          | SH.T NO.1 2              |
| 0.000 = ±.03                           |                        | DWG NO. FPCXX-T1T1-2000-A        |                          |
| 0° = ± 1'                              |                        |                                  |                          |
| 0.0° = ±.50°                           |                        |                                  |                          |

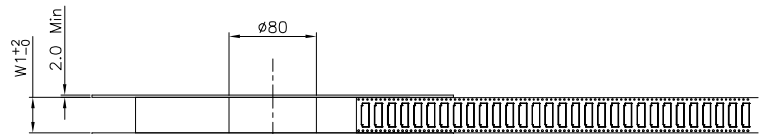

- NOTES:
1. 10 SPROCKET HOLE PITCH CUMULATIVE TOLERANCE.±0.20mm
  2. CARRIER CAMBER NOT TO EXCEED 1mm IN 250mm.
  3. ALL DIMENSIONS MEET EIA-481-C REQUIREMENTS.
  4. MATERIAL: XXXXX ANTI-STATIC POLYSTYRENE.
  5. THICKNESS: 0.35 ± 0.05 mm.
  6. PACKING LENGTH PER 13" REEL : 24.60METERS.
  7. COMPONENT LOAD PER 13" REEL : 2000PCS.
  8. PEELING OFF FORCE OF TOP TAPE 0.1N~0.7N(10.2gf~71.4gf).

EB-650XXX230-XX

00:黑色  
01:白色

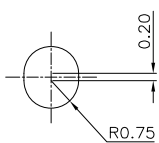
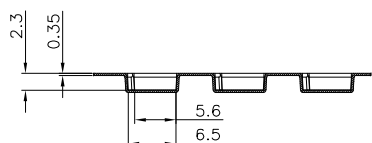
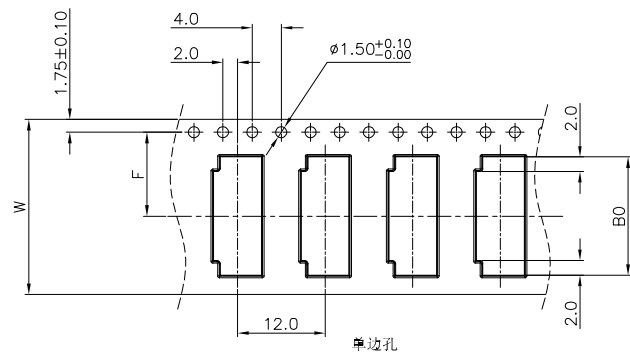
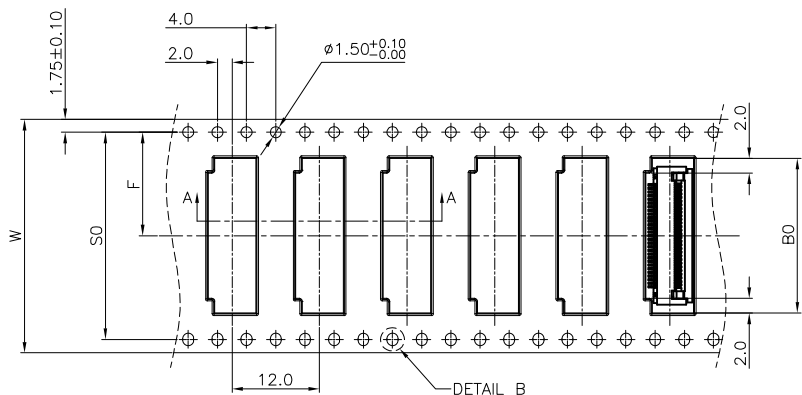
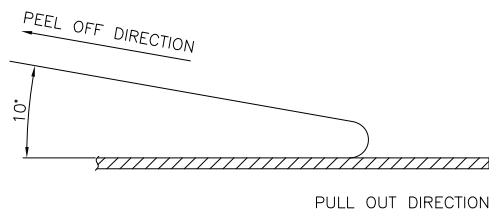
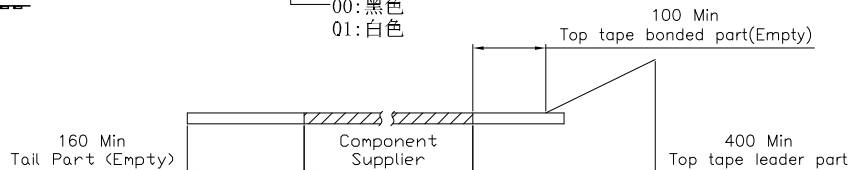
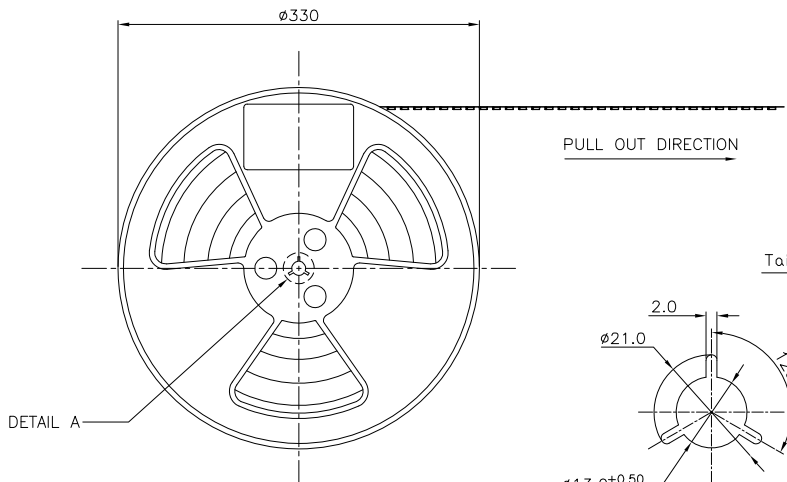

SECTION A-A  
SCALE 1:1

DETAIL B  
SCALE 5:1

| CKTS | B0±0.10 | W         | W1   | F         | S0±0.10 |
|------|---------|-----------|------|-----------|---------|
| 4    | 6.70    | 16+0.3/-0 | 16.4 | 7.5±0.10  | 单边孔     |
| 5    | 7.20    |           |      |           |         |
| 6    | 7.70    |           |      |           |         |
| 7    | 8.20    |           |      |           |         |
| 8    | 8.70    |           |      |           |         |
| 9    | 9.20    |           |      |           |         |
| 10   | 9.70    |           |      |           |         |
| 11   | 10.20   |           |      |           |         |
| 12   | 10.70   |           |      |           |         |
| 13   | 11.20   |           |      |           |         |
| 14   | 11.70   | 24+0.3/-0 | 24.4 | 11.5±0.10 | 单边孔     |
| 15   | 12.20   |           |      |           |         |
| 16   | 12.70   |           |      |           |         |
| 17   | 13.20   |           |      |           |         |
| 18   | 13.70   |           |      |           |         |
| 19   | 14.20   |           |      |           |         |
| 20   | 14.70   |           |      |           |         |
| 21   | 15.20   |           |      |           |         |
| 22   | 15.70   |           |      |           |         |
| 23   | 16.20   |           |      |           |         |
| 24   | 16.70   | 32±0.30   | 32.4 | 14.2±0.10 | 28.4    |
| 25   | 17.20   |           |      |           |         |
| 26   | 17.70   |           |      |           |         |
| 27   | 18.20   |           |      |           |         |
| 28   | 18.70   |           |      |           |         |
| 29   | 19.20   |           |      |           |         |
| 30   | 19.70   |           |      |           |         |
| 31   | 20.20   |           |      |           |         |
| 32   | 20.70   |           |      |           |         |
| 33   | 21.20   |           |      |           |         |
| 34   | 21.70   | 44±0.30   | 44.4 | 20.2±0.15 | 40.4    |
| 35   | 22.20   |           |      |           |         |
| 36   | 22.70   |           |      |           |         |
| 37   | 23.20   |           |      |           |         |
| 38   | 23.70   |           |      |           |         |
| 39   | 24.20   |           |      |           |         |
| 40   | 24.70   |           |      |           |         |
| 41   | 25.20   |           |      |           |         |
| 42   | 25.70   |           |      |           |         |
| 43   | 26.20   |           |      |           |         |
| 44   | 26.70   | 56±0.30   | 56.4 | 26.2±0.15 | 52.4    |
| 45   | 27.20   |           |      |           |         |
| 46   | 27.70   |           |      |           |         |
| 47   | 28.20   |           |      |           |         |
| 48   | 28.70   |           |      |           |         |
| 49   | 29.20   |           |      |           |         |
| 50   | 29.70   |           |      |           |         |
| 51   | 30.20   |           |      |           |         |
| 52   | 30.70   |           |      |           |         |
| 53   | 31.20   |           |      |           |         |
| 54   | 31.70   |           |      |           |         |
| 55   | 32.20   |           |      |           |         |
| 56   | 32.70   |           |      |           |         |
| 57   | 33.20   |           |      |           |         |
| 58   | 33.70   |           |      |           |         |
| 59   | 34.20   |           |      |           |         |
| 60   | 34.70   |           |      |           |         |

|   |              |                                  |          |                                   |       |
|---|--------------|----------------------------------|----------|-----------------------------------|-------|
| -TOLERANCES-<br>UNLESS OTHERWISE SPECIFIED<br>公差参考表 |              | 东莞市高钺达电子科技有限公司<br>惠州市高钺达光电科技有限公司 |          |                                   |       |
|   |              |                                  |          | PART NO.<br>产品料号:                 |       |
| X.X : ±0.15   | X.X° : ±5°   | APPD:<br>核准:                     | ZHANGHAO | TITLE:<br>产品名称: FPC 0.5mm 2.0H载带图 |       |
| X.XX : ±0.10  | X.XX° : ±3°  | CHECK:<br>校对:                    | JOHNSON  | DATE                              | SCALE |
| X.XXX : ±0.05                                       | X.XXX° : ±1° | DRAW:<br>繪圖:                     | HOHNSON  | 20110907                          | 1:1   |
|   |              |                                  |          | UNIT                              | mm    |
|   |              |                                  |          | PAGE                              | 1/1   |

|                       |                              |       |              |
|-----------------------|------------------------------|-------|--------------|
|                       |                              | 文件編號： |              |
|                       |                              | 修訂日期： | 2021-09-26   |
| 0.5mm 2.0H<br>FPC/FFC | <b>Product Specification</b> | 版 次：  | <b>Rev A</b> |
|                       |                              | 頁 次：  | 1 of 7       |

**【1】 适用范围 SCOPE**

本规格书适用于 0.5mmPitch FPC 拉拔卧式 SMT 型连接器系列。

This specification covers the 0.5mmPitch FPC ZIF R/A SMT Type Connectors series.

**【2】 外观尺寸 CONNECTOR DIMENSIONS**

请参照图面

See attached drawings.

**【3】 材质 MATERIAL**

绝缘胶体 Housing: LCP

颜色 Color:白色 White

耐燃等级 (UL94V-0) Flammability Rating (UL94V-0).

后盖 Actuator: LCP

颜色 Color:黑色 Black

耐燃等级 (UL94V-0) Flammability Rating (UL94V-0).

端子 Terminal: 磷青铜 Phosphor Bronze.

焊片 Fitting Nail: 黄铜 Brass.

**【4】 建议 P. C. B LAYOUT 图 ACCOMMODATED P. C. B LAYOUT**

请参照图面

See attached drawings.

**【5】 等级 RATING**

| 项 目<br>ITEM                           | 规 格<br>SPECIFICATIONS                   |
|---------------------------------------|---|
| 最大容许电压<br>Operating Voltage(Max.)     | 50V AC                                  |
| 最大容许电流<br>Current Rating(Max.)        | 0.4A DC                                 |
| 使用温度范围<br>Operating Temperature range | -25°C ~ +85°C                           |
| 使用湿度范围<br>Operating humidity range    | 相对湿度90%以下<br>Relative humidity 90% max. |
| 保存温度范围<br>Storage temperature range   | -10°C ~ +50°C                           |
| 保存湿度范围<br>Storage humidity range      | 相对湿度90%以下<br>Relative humidity 90% max. |

\*: 包含电流通过所产生的上升温度 Including terminal temperature rise.

|                       |                              |       |              |
|-----------------------|------------------------------|-------|--------------|
|                       |                              | 文件編號： |              |
|                       |                              | 修訂日期： | 2021-09-26   |
| 0.5mm 2.0H<br>FPC/FFC | <b>Product Specification</b> | 版 次：  | <b>Rev A</b> |
|                       |                              | 頁 次：  | 2 of 7       |

## 【6】性能 PERFORMANCE

### 6.1 电气特性 ELECTRICAL PERFORMANCE

| 项目<br>ITEM                    | 测试条件<br>TEST CONDITION   | 规格<br>REQUIRMENT            |
|-------------------------------|--|-----------------------------|
| 接触阻抗<br>Contact Resistance    | 将样品与适合之FPC连接, 测试电压20mV, 限电流10mA下进行阻抗测试。(EIA-364-23)<br>Mate applicable FPC and measure by dry circuit, 20mV Max, 10mA. (EIA-364-23)                          | 40 mΩ最大.<br>40 mΩ Max.      |
| 绝缘阻抗<br>Insulation Resistance | 将样品与适合之FPC连接, 提供相邻端子间测试电压500V DC进行绝缘阻抗测试(EIA-364-21)<br>Mate applicable FPC and apply 500V DC between adjacent terminal or ground. (EIA-364-21)              | 500MΩ最小.<br>500 MΩ Min.     |
| 耐电压<br>Dielectric Strength    | 将样品与适合之FPC连接, 相邻端子间需可承受250V AC(rms) 1分钟。(EIA-364-20)<br>Mate applicable FPC, apply 250V AC(rms) for1 minute between adjacent terminal or ground.(EIA-364-20) | 目视外观无任何损坏异状<br>No Breakdown |

### 6.2 机械特性 MECHANICAL PERFORMANCE

| 项目<br>ITEM                        | 测试条件<br>TEST CONDITION  | 规格<br>REQUIRMENT                |
|-----------------------------------|---|---------------------------------|
| FPC保持力<br>FPC Retention Force     | 将盖子盖上, 与FPC连接, 以操作速度每分钟位移25±3mm进行FPC保持力测试。<br>Insert the actuator, pull the FPC at a rate of 25±3mm per minute.   | Pos.x 0.3N最小<br>Pos.x 0.3N Min. |
| 端子保持力<br>Terminal Retention Force | 端子与Housing组装后, 以操作速度每分钟位移25±3mm将端子拔出Housing, 进行端子保持力测试。<br>Apply axial pull out force at the rate of 25±3 mm/minute on the terminal assembled in the housing. | 3N最小.<br>3N Min.                |

|                       |                              |       |              |
|-----------------------|------------------------------|-------|--------------|
|                       |                              | 文件編號： |              |
|                       |                              | 修訂日期： | 2021-09-26   |
| 0.5mm 2.0H<br>FPC/FFC | <b>Product Specification</b> | 版 次：  | <b>Rev A</b> |
|                       |                              | 頁 次：  | 3 of 7       |

| 项目<br>ITEM                               | 测试条件<br>TEST CONDITION  | 规格<br>REQUIREMENT |
|--|---|-------------------|
| 焊片保持力<br>Fitting Nail Retention<br>Force | 焊片与Housing组装后，以操作速度每分钟位移 $25\pm 3$ mm将焊片拔出Housing，进行焊片保持力测试。<br>Apply axial pull out force at the rate of $25\pm 3$ mm/minute on the Fitting Nail assembled in the housing. | 1N最小.<br>1N Min   |

### 6.3 环境特性及其它性能 ENVIRONMENTAL PERFORMANCE AND OTHERS

| 项目<br>ITEM               | 测试条件<br>TEST CONDITION  | 规格<br>REQUIREMENT             |                           |
|--------------------------|---|-------------------------------|---------------------------|
| 耐久性<br>Durability        | 将盖子与FPC反复连接，以每分钟小于10 cycles连续操作20次。<br>Insert and withdraw actuator up to 20 cycles at the speed rate of less than 10 cycles/minute.  | 接触阻抗<br>Contact<br>Resistance | 60mΩ最大.<br>60mΩ Max.      |
| 温度上升<br>Temperature Rise | 量测通过FPC最大容许电流时，样品接触点之温升 (EIA-364-70 METHOD 2)<br>Mate applicable FPC and measure the temperature rise of contact when the maximum AC rated current is passed. (EIA-364-70 METHOD 2)   | 温升<br>Temperature<br>rise     | 30°C最大.<br>30°C Max.      |
| 耐振性<br>Vibration         | 通过DC电流1mA，位移相对距离1.5mm，振动周期10~55~10 Hz在1分钟内，持续2小时，方向在X,Y,Z轴做测试。(EIA-364-28 Condition I)<br>Mate connectors and subject to the following vibration conditions, for period of 2 hours in each of 3 mutually perpendicular axes, passing DC 1mA during the test. Amplitude : 1.5mm P-P Frequency : 10~55~10 Hz in 1 minute. Duration : 2 hours in each of X,Y,Z axes.<br>(EIA-364-28 Condition I) | 外观<br>Appearance              | 目视外观无任何损坏异状<br>NoDamage   |
|                          |   | 接触阻抗<br>Contact<br>Resistance | 60mΩ最大.<br>60mΩ Max.      |
|                          |   | 瞬间断电<br>Discontinuity         | 1 μ sec最大<br>1 μ sec Max. |

|                       |                              |       |              |
|-----------------------|------------------------------|-------|--------------|
|                       |                              | 文件編號： |              |
|                       |                              | 修訂日期： | 2021-09-26   |
| 0.5mm 2.0H<br>FPC/FFC | <b>Product Specification</b> | 版 次：  | <b>Rev A</b> |
|                       |                              | 頁 次：  | 4 of 7       |

| 項目<br>ITEM             | 測試條件<br>TEST CONDITION   | 規格<br>REQUIRMENT           |                            |
|------------------------|--|----------------------------|----------------------------|
| 耐衝擊性<br>Shock          | 將樣品與適合之FPC連接，通過DC 1 mA測試條件，連續測試3次。在X、Y、Z 3軸6個垂直方向施予重力加速度490m/s <sup>2</sup> {50G} 衝擊。<br>(EIA-364-27, test condition A)<br>Mate applicable FPC and subject to the following shock conditions. 3 times of shocks shall be applied for each 6 directions along 3 mutually perpendicular axes, passing DC 1 mA current during the test. (Total of 18 shocks) Peak value : 490m/s <sup>2</sup> {50G}(EIA-364-27, test condition A) | 外觀<br>Appearance           | 目視外觀無任何損壞異狀<br>NoDamage    |
|                        |  | 接觸阻抗<br>Contact Resistance | 60mΩ 最大.<br>60mΩ Max.      |
|                        |  | 瞬斷電<br>Discontinuity       | 1 μ sec 最大<br>1 μ sec Max. |
| 耐熱性<br>Heat Resistance | 將樣品與適合之FPC連接，置於環境溫度85±2°C測試時間96小時，再置放於室溫下1~2小時。<br>Mate applicable FPC and expose to 85±2°C for 96 hours. Upon completion of the exposure period, the test specimens shall be conditioned at ambient room conditions for 1 to 2 hours, after which the specified measurements shall be performed.  | 外觀<br>Appearance           | 目視外觀無任何損壞異狀<br>NoDamage    |
|                        |  | 接觸阻抗<br>Contact Resistance | 60mΩ 最大.<br>60mΩ Max.      |
| 耐寒性<br>Cold Resistance | 將樣品與適合之FPC連接，置於環境溫度-40±2°C，測試時間96小時，再置放於室溫下1~2小時。<br>Mate applicable FPC and expose to -40±2°C for 96 hours. Upon completion of the exposure period, the test specimens shall be conditioned at ambient room conditions for 1 to 2 hours, after which the specified measurements shall be performed.   | 外觀<br>Appearance           | 目視外觀無任何損壞異狀<br>NoDamage    |
|                        |  | 接觸阻抗<br>Contact Resistance | 60mΩ 最大.<br>60mΩ Max.      |

|                       |                              |       |              |
|-----------------------|------------------------------|-------|--------------|
|                       |                              | 文件編號： |              |
|                       |                              | 修訂日期： | 2021-09-26   |
| 0.5mm 2.0H<br>FPC/FFC | <b>Product Specification</b> | 版 次：  | <b>Rev A</b> |
|                       |                              | 頁 次：  | 5 of 7       |

| 项目<br>ITEM                  | 测试条件<br>TEST CONDITION   | 规格<br>REQUIRMENT                |                           |
|-----------------------------|--|---------------------------------|---------------------------|
| 耐湿性<br>Humidity             | 将样品与适合之FPC连接，置于环境温度60±2°C，相对湿度90~95%，测试时间96小时，再置放于室温下1~2小时。<br>Mate applicable FPC and expose to 60 ± 2°C, relative humidity 90 to 95% for 96 hours. Upon completion of the exposure period, the test specimens shall be conditioned at ambient room conditions for 1 to 2 hours, after which the specified measurements shall be performed.   | 外观<br>Appearance                | 目视外观无任何损坏异状<br>NoDamage   |
|                             |  | 接触阻抗<br>Contact Resistance      | 60mΩ最大.<br>60mΩMax.       |
|                             |  | 耐电压<br>Dielectric Strength      | 需能符合耐电压测试<br>No Breakdown |
|                             |  | 绝缘阻抗<br>Insulation t Resistance | 40 MΩ 最小.<br>40 MΩ Min    |
| 冷热冲击<br>Temperature Cycling | 将样品与适合之FPC连接，承受5 cycles冷热冲击后置放于室温下1~2小时。1 cycle time如下<br>a) -55±3°C 30分钟<br>b) +85±3°C 30分钟<br>Mate applicable FPC and subject to the following conditions for 5 cycles. Upon completion of the exposure period, the test specimens shall be conditioned at ambient room conditions for 1 to 2 hours, after which the specified measurements shall be performed. 1 cycle<br>a) -55±3°C 30minutes<br>b) +85±3°C 30minutes    | 外观<br>Appearance                | 目视外观无任何损坏异状<br>NoDamage   |
|                             |  | 接触阻抗<br>Contact Resistance      | 60mΩ 最大.<br>60mΩ Max.     |
| 盐水喷雾<br>Salt Spray          | 将样品与适合之FPC连接，使用5±1%浓度盐水，测试温度35±2°C，测试时间 8±4小时,后于室温下使用清水冲洗后再干燥。<br>Mate applicable FPC and expose to the following salt mist conditions. Upon completion of the exposure period, salt deposits shall be removed by a gentle wash or dip in running water, after which the specified measurements shall be performed.<br>NaCl solution<br>Concentration : 5 ± 1%<br>Spray time : 8 ± 4 hours<br>Ambient temperature : 35 ± 2°C | 外观<br>Appearance                | 目视外观无任何损坏异状<br>NoDamage   |
|                             |  | 接触阻抗<br>Contact Resistance      | 60mΩ 最大.<br>60mΩ Max.     |

|                       |                              |       |              |
|-----------------------|------------------------------|-------|--------------|
|                       |                              | 文件編號： |              |
|                       |                              | 修訂日期： | 2021-09-26   |
| 0.5mm 2.0H<br>FPC/FFC | <b>Product Specification</b> | 版 次：  | <b>Rev A</b> |
|                       |                              | 頁 次：  | 6 of 7       |

| 项目<br>ITEM                            | 测试条件<br>TEST CONDITION  | 规格<br>REQUIRMENT           |   |
|---------------------------------------|---|----------------------------|---|
| 二氧化硫(气体)<br>SO2 Gas                   | 将样品与适合之FPC连接，将其置于50±5 ppm浓度二氧化硫气体中，测试温度40±2°C，测试时间24小时。<br>Mate applicable FPC and expose them to the following SO2 gas atmosphere.<br>Temperature 40 ± 2°C<br>Gas Density 50 ± 5 ppm<br>Duration 24 hours                  | 外观<br>Appearance           | 目视外观无任何损坏异状<br>NoDamage   |
|                                       |   | 接触阻抗<br>Contact Resistance | 60mΩ 最大.<br>60mΩ Max.   |
| 氨(气体)<br>NH3 Gas                      | 暴露来自浓度28%阿摩尼亚之蒸发气体NH3中，测试时间40分钟。<br>40 minutes exposure to NH3 gas evaporating from 28% Ammonia solution.   | 外观<br>Appearance           | 目视外观无任何损坏异状<br>NoDamage   |
|                                       |   | 接触阻抗<br>Contact Resistance | 60mΩ 最大.<br>60mΩ Max.   |
| 焊锡性<br>Solderability                  | 锡温245±5°C，将导电端子浸入锡炉液面至Housing距离锡面0.1mm位置，焊锡时间3±0.5秒。<br>Tip of solder tails and fitting nails into the molten solder (held at 245±5°C) up to 0.1mm from the bottom of the housing for 3±0.5 seconds.                        | 润湿性<br>Solder Wetting      | 润湿面积75%以上，并不得有漏焊针孔现象<br>75% of immersed area must show no voids, pin holes. |
| 焊锡耐热性<br>Resistance to Soldering Heat | 使用红外线回焊时请参考第7<br>When reflowing Refer to paragraph 7.<br>使用烙铁手焊时须可符合下述焊锡条件<br>Soldering iron method<br>0.3mm from terminal tip and fitting nail tip.<br>Soldering time : 3 seconds Max.<br>Solder temperature : 370 ~ 400°C | 外观<br>Appearance           | 目视外观无任何损坏异状<br>NoDamage   |

|                       |                              |       |              |
|-----------------------|------------------------------|-------|--------------|
|                       |                              | 文件編號： |              |
|                       |                              | 修訂日期： | 2021-09-26   |
| 0.5mm 2.0H<br>FPC/FFC | <b>Product Specification</b> | 版 次：  | <b>Rev A</b> |
|                       |                              | 頁 次：  | 7 of 7       |

**【7】 红外线回焊温度曲线 INFRARED REFLOW CONDITION**

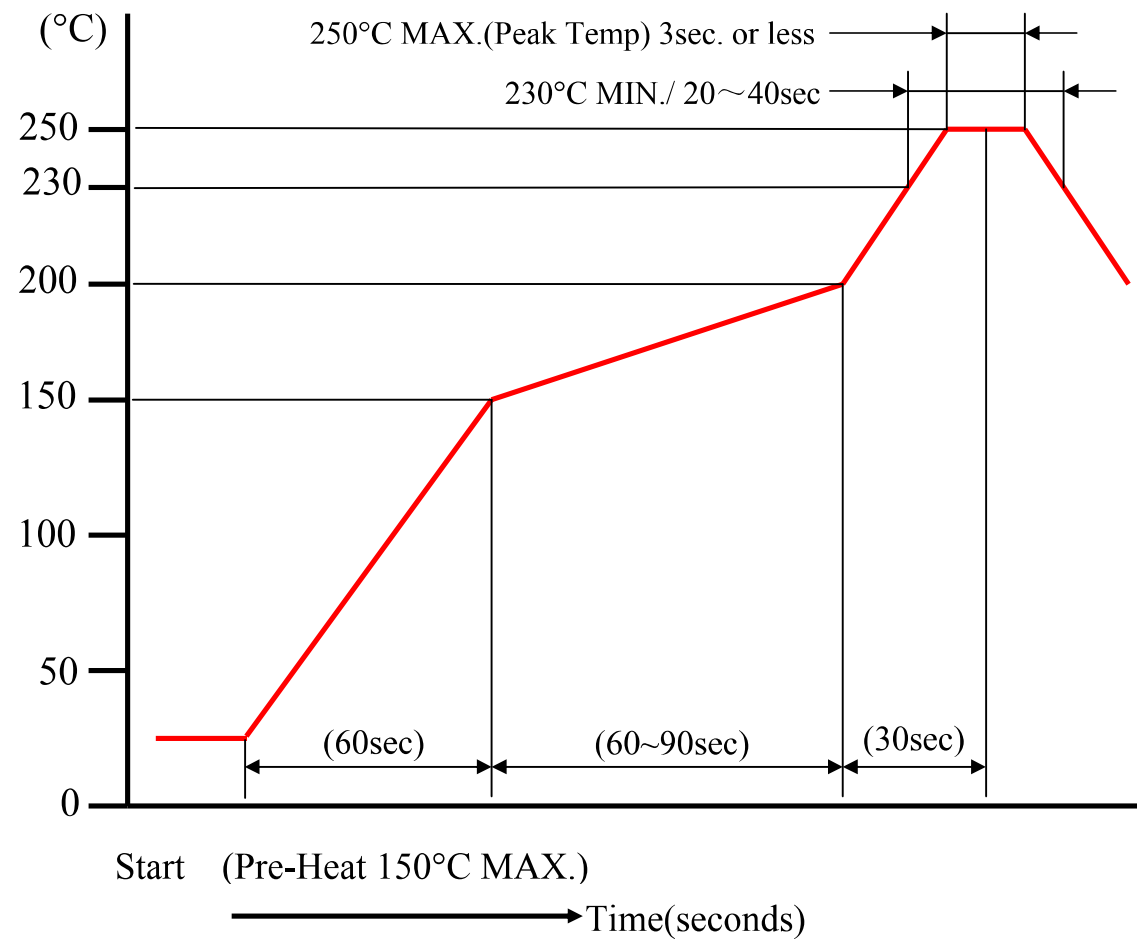

温度条件TEMPERATURE CONDITION GRAPH  
(基板表面温度) (TEMPERATURE ON BOARD PATTERN SIDE)