

Features

- General rectification
- Low V_F ; Low I_R
- High reliability

Applications

- surface mount schottky barrier rectifier

Ordering Information

- Shipping Qty:8000/7inch Tape& Reel

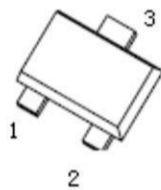

SOT-723

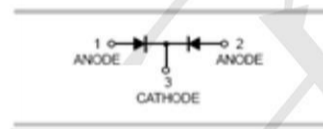

Absolute Maximum Ratings ($T_A=25^\circ\text{C}$ unless otherwise noted)

Parameter	Symbol	Value	Unit
Peak Repetitive Reverse Voltage	V_{RRM}		
Working Peak Reverse Voltage	V_{RWM}	40	V
DC Reverse Voltage	V_R		
Maximum Average Forward Output Current	$I_{F(AV)}$	200	mA
Repetitive Peak Forward Current	I_{FRM}	300	mA
Forward Surge Current @ $t_p < 1s$	I_{FSM}	600	mA

Thermal Characteristics

Parameter	Symbol	Value	Unit
Power Dissipation	P_D	150	mW
Thermal Resistance (Junction-to-Ambient)	$R_{\theta JA}$	667	$^\circ\text{C/W}$
Thermal Resistance (Junction-to-Case)	$R_{\theta JC}$	480	$^\circ\text{C/W}$
Operating junction Temperature	T_J	-55 ~ +125	$^\circ\text{C}$
Storage Temperature Range	T_{STG}	-55 ~ +150	$^\circ\text{C}$

Electrical Characteristics ($T_A=25^\circ\text{C}$ unless otherwise noted)

Parameter	Symbol	Test Condition	Min.	Typ.	Max.	Unit
Reverse Breakdown Voltage	$V_{(BR)}$	$I_R = 100\mu\text{A}$	40	-	-	V
Forward Voltage *1	V_F	$I_F = 0.1\text{mA}$	-	-	0.24	V
		$I_F = 1\text{mA}$	-	-	0.32	V
		$I_F = 10\text{mA}$	-	-	0.40	V
		$I_F = 30\text{mA}$	-	-	0.50	V
		$I_F = 100\text{mA}$	-	-	1	V
Maximum Peak Reverse Current *2	I_R	$V_R = 25\text{V}$	-	-	3	μA
Capacitance Between Terminals	C_T	$V_R = 1\text{V}, f = 1\text{MHz}$	-	-	10	pF
Reverse Recovery Time	t_{rr}	$I_F = I_R = 10\text{mA}$ $I_{rr} = 0.1 \cdot I_R, R_L = 100\Omega$	-	-	5	ns

*1: pulse test, $t_p \leq 300\mu\text{s}$
*2: pulse test, $t_p \leq 5\text{ms}$

Typical Electrical Characteristic Curves

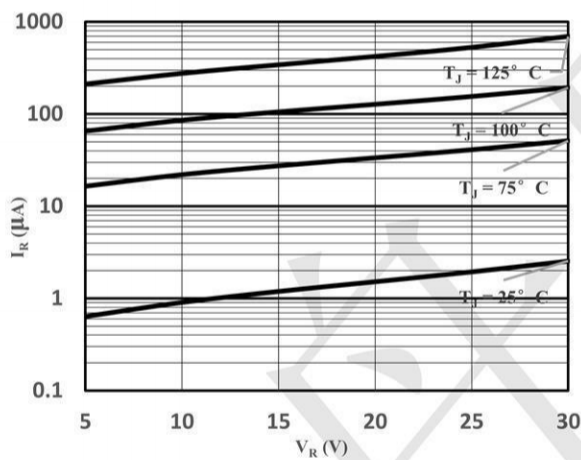

Fig 1 Typical Reverse Characteristic

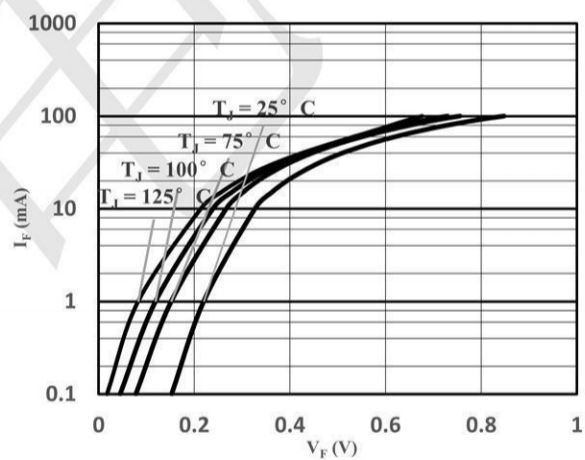

Fig 2 Typical Forward Characteristics

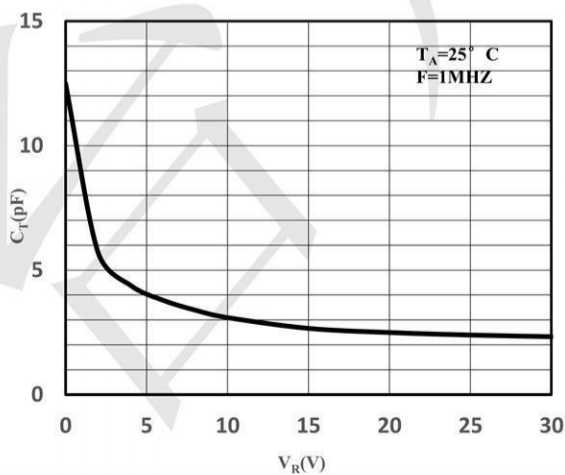

Fig 3 Capacitance Characteristics

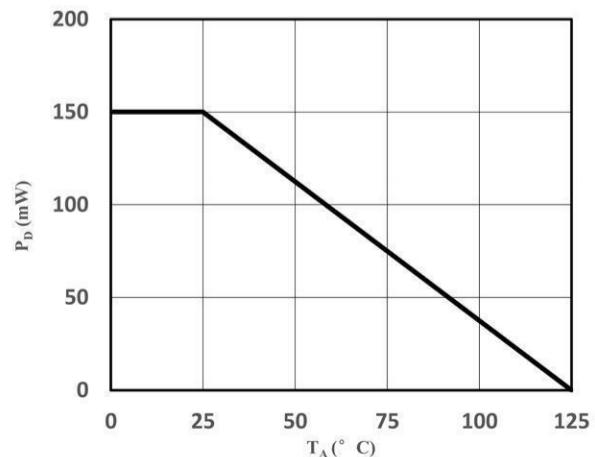
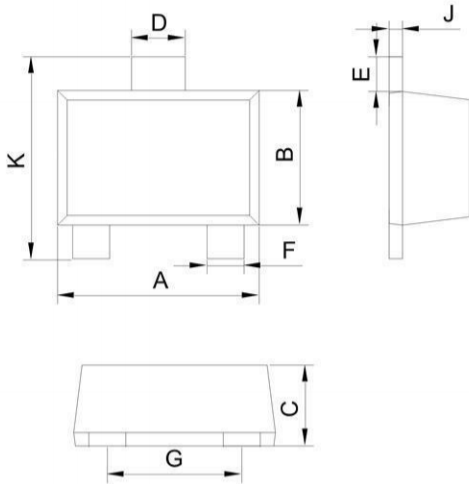

Fig 4 Derating Curve

Outline Drawing - SOT-723 (unit: mm)



SOT-723		
Dimension	Min.	Max.
A	1.10	1.30
B	0.70	0.90
C	0.40	0.54
D	0.22	0.42
E	0.10	0.30
F	0.12	0.32
G	0.70	0.90
J	0.08	0.15
K	1.10	1.30

Mounting Pad Layout-SOT723 (unit: mm)

