

SPECIFICATIONS

Current Rating: 3Amps
 Insulation Resistance: 1000MΩ Min
 Contact Resistance: 20mΩ Max
 Withstanding Voltage: AC 1000V
 Operation Temperature: -40° to +105°
 Contact Material: Brass
 Standard: PA6T
 Insulator Material: Polyester (UL 94V-0)
 Contact Plating: Gold Flash
 Max. Processing Temp: 240°C for 30-60 seconds
 (260°C for 5 seconds)

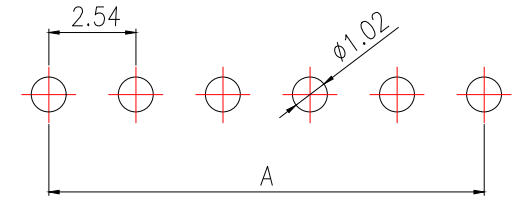

RECOMMEND P.C.B LAYOUT
 PCB TOLERANCE: ±0.05 (TOP VIEW)

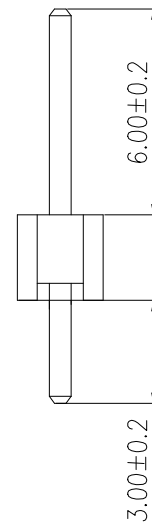
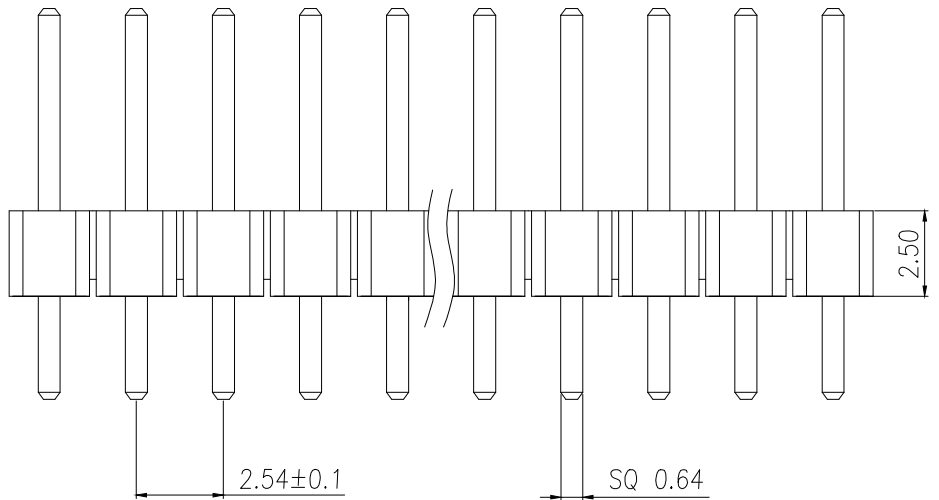
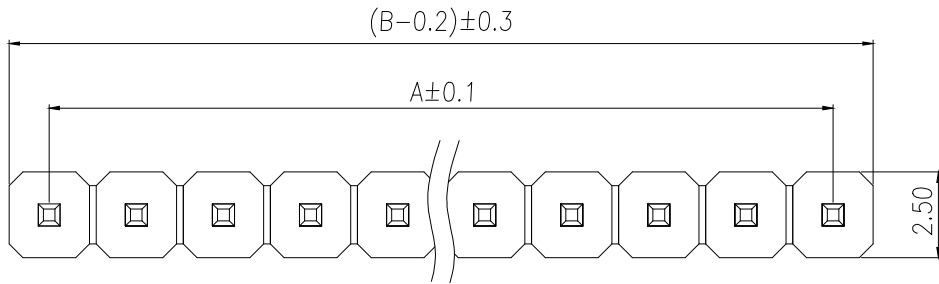

| P/N | PIN | DIM.A | DIM.B |
|-------------------|-------|--------------|------------|
| BX-PZ2.54-1-1PZZ | 1 | 0.00 | 2.54 |
| BX-PZ2.54-1-2PZZ | 2 | 2.54 | 5.08 |
| BX-PZ2.54-1-3PZZ | 3 | 5.08 | 7.62 |
| BX-PZ2.54-1-4PZZ | 4 | 7.62 | 10.16 |
| BX-PZ2.54-1-5PZZ | 5 | 10.16 | 12.70 |
| BX-PZ2.54-1-6PZZ | 6 | 12.70 | 15.24 |
| BX-PZ2.54-1-7PZZ | 7 | 15.24 | 17.78 |
| BX-PZ2.54-1-8PZZ | 8 | 17.78 | 20.32 |
| BX-PZ2.54-1-9PZZ | 9 | 20.32 | 22.86 |
| | | | |
| BX-PZ2.54-1-40PZZ | 40 | (PIN-1)X2.54 | (PIN)X2.54 |

| | | | | | | | | | | |
|-------------|---------------------|------------|-------------------|------------|---------------|------|-------------|-----|----------------|------|
| 制图 DRAWN | 变更内容 DESCRIPTION | 日期 DATE | GENERAL TOLERANCE | | 制图 DRAWING | EMMA | | | | |
| | | | X.±0.30 | X.*±5° | | | 审核 CHECK | EVA | | |
| | | | .X±0.20 | .X.*±1° | | | | | 核准 APPROVAL | JADE |
| | | | .XX±0.10 | .XX.*±0.5° | | | | | | |

| | | | |
|------------------|---|-------------|-----|
| 料号 PART NO. | BX-PZ2.54-1-NPZZ | 版本 REV. | A |
| 品名 TITLE | 2.54PH H2.5 1xPin 180μ PC3.0 PA6.0 PB2.5 L11.5 6T | | |
| 客户料号 CUTM.NO. | | 页次 SHEET | 1/1 |