

Ring common mode inductors

Core:T080-125

Copper wire:2UEW

VARNISH:E962-W



Part Number	Electrical Specifications @25°C				
	Core	Inductance (1.0KHZ/0.25V) (uH Min)	Turns	DCR pin1-2 (mΩ Max)	HI-POT pin1-2 (60S 1mA Max)
T080-125-450HD-K0903	T080-125	45 ± 15%	1.20mm*24TS	11	600Vac

MECHANICAL

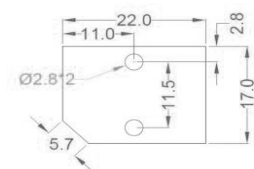
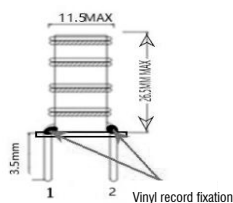
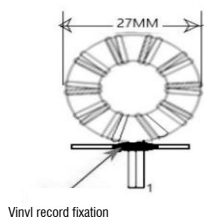

(UNIT: mm)

SCHEMATICS

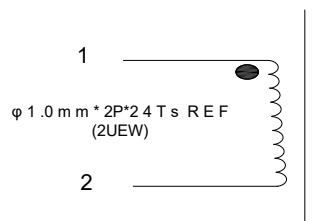

Remark

- 1.Product outer jacket heat shrink tubing. The product does not require oiling.
- 2.The foam thickness is 5mm thicker than the pin length
(Prevent component deformation)