

PCB 寸法
PCB Layout

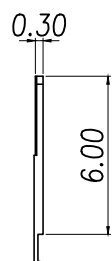
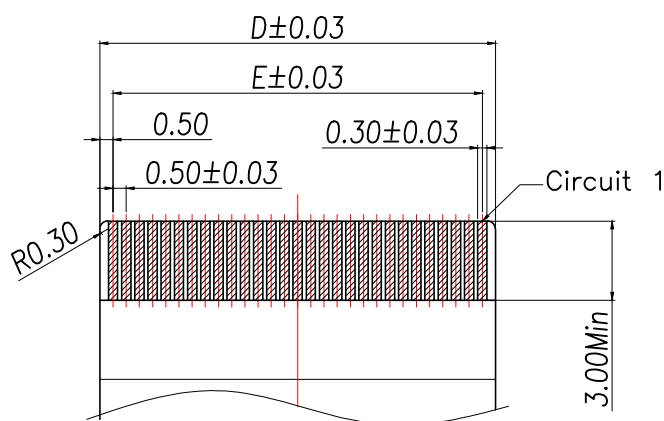

NOTES: RECOMMENDED FPC/FFC DIMENSION

- 额定电流 Current rating: 0.5A
- 额定电压 Voltage rating: 50V
- 耐电压 Withstand voltage: 500V AC/minute
- 接触电阻 Contact resistance: $\leq 40m\Omega$
- 绝缘电阻 Insulation resistance: 100MΩ MIN
- 工作温度 Working temperature: -25℃ ~ +85℃
- 盐雾测试 Salt spray test: 24H
- 触点高低PIN不大于0.05mm.

Part No	Pin	A	B	C	D	E	F
BX-FPC05-2H6PX	6	7.4	2.50	3.6	3.50	2.50	2.50
BX-FPC05-2H8PX	8	8.4	3.50	4.6	4.50	3.50	3.50
BX-FPC05-2H10PX	10	9.4	4.50	5.6	5.50	4.50	4.50
BX-FPC05-2H12PX	12	10.4	5.50	6.6	6.50	5.50	5.50
BX-FPC05-2H14PX	14	11.4	6.50	7.6	7.50	6.50	6.50
BX-FPC05-2H16PX	16	12.4	7.50	8.6	8.50	7.50	7.50
BX-FPC05-2H18PX	18	13.4	8.50	9.6	9.50	8.50	8.50
BX-FPC05-2H20PX	20	14.4	9.50	10.6	10.50	9.50	9.50
BX-FPC05-2H22PX	22	15.4	10.50	11.6	11.50	10.50	10.50
BX-FPC05-2H24PX	24	16.4	11.50	12.6	12.50	11.50	11.50
BX-FPC05-2H26PX	26	17.4	12.50	13.6	13.50	12.50	12.50
BX-FPC05-2H28PX	28	18.4	13.50	14.6	14.50	13.50	13.50
BX-FPC05-2H30PX	30	19.4	14.50	15.6	15.50	14.50	14.50
BX-FPC05-2H32PX	32	20.4	15.50	16.6	16.5	15.50	15.50
BX-FPC05-2H34PX	34	21.4	16.5	17.6	17.5	16.5	16.5
BX-FPC05-2H36PX	36	22.4	17.5	18.6	18.5	17.5	17.5
BX-FPC05-2H40PX	40	24.4	18.5	20.6	20.5	18.5	18.5
BX-FPC05-2H50PX	50	29.4	24.5	25.6	25.5	24.5	24.5

制图 DRAWN	变更内容 DESCRIPTION	日期 DATE	GENERAL TOLERANCE		制图 DRAWING	EMMA		料号 PART NO.	BX-FPC05-2HNPX		版次 REV.	A
			X.±0.35	X.*±3°	审核 CHECK	EVA		品名 TITLE	FPC 0.5PH H2.0 首端下接		页次 SHEET	1/1
			.X±0.25	.X.*±2°	核准 APPROVAL	JADE		客户料号 CUTM.NO.				
			.XX±0.15		单位 UNITS	MM	比例 SCALE	1:1				