

SPECIFICATIONS

Current Rating: 3Amps
 Insulation Resistance: 1000MΩ Min
 Contact Resistance: 20mΩ Max
 Withstanding Voltage: AC 1000V
 Operation Temperature: -40°to+105°
 Contact Material: Brass
 Insulator Material: Polyester(UL 94V-0)
 Contact plating: Gold Flash
 Standard: PA6T
 Max.Processing Temp: 240°C for30-60seconds
 (260°Cfor10seconds)

P/N	PIN	DIM.A	DIM.B
BX-IDC2.54-2-3PZZ	2*3	5.08	7.62
BX-IDC2.54-2-4PZZ	2*4	7.62	10.16
BX-IDC2.54-2-5PZZ	2*5	10.16	12.70
BX-IDC2.54-2-6PZZ	2*6	12.70	15.24
BX-IDC2.54-2-7PZZ	2*7	15.24	17.78
BX-IDC2.54-2-8PZZ	2*8	17.78	20.32
BX-IDC2.54-2-9PZZ	2*9	20.32	22.86
BX-IDC2.54-2-10PZZ	2*10	22.86	25.40
BX-IDC2.54-2-12PZZ	2*12	27.94	30.48
BX-IDC2.54-2-13PZZ	2*13	30.48	33.02
BX-IDC2.54-2-14PZZ	2*14	33.02	35.56
BX-IDC2.54-2-15PZZ	2*15	35.56	38.10
BX-IDC2.54-2-16PZZ	2*16	38.10	40.64
BX-IDC2.54-2-17PZZ	2*17	40.64	43.18
BX-IDC2.54-2-18PZZ	2*18	43.18	45.72
BX-IDC2.54-2-20PZZ	2*20	48.26	50.80
BX-IDC2.54-2-22PZZ	2*22	53.34	55.88
BX-IDC2.54-2-25PZZ	2*25	60.96	63.50
BX-IDC2.54-2-30PZZ	2*30	73.66	76.20
BX-IDC2.54-2-32PZZ	2*32	78.74	81.28

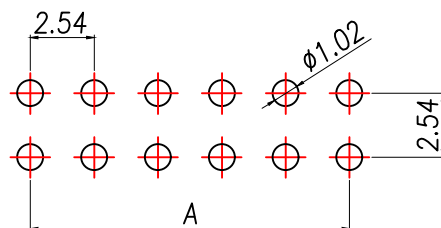
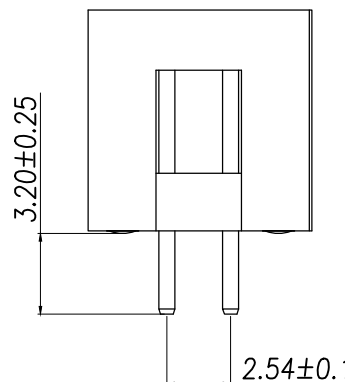
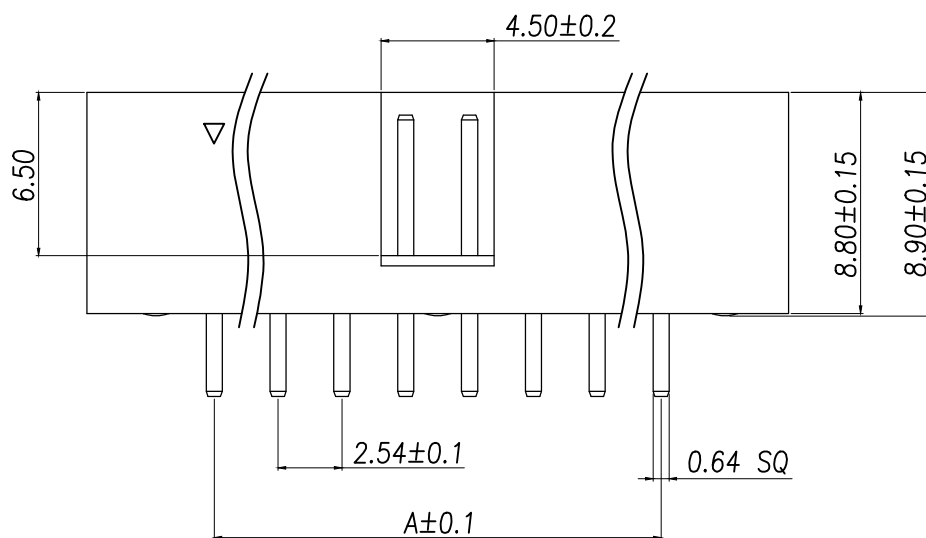

RECOMMEND P.C.B LAYOUT
 PCB TOLERANCE:±0.05 (TOP VIEW)

制图 DRAWN	变更内容 DESCRIPTION	日期 DATE	GENERAL TOLERANCE		制图 DRAWING	料号 PART NO.	版本 REV.	A
			X.±0.30	X.°±5°	EMMA	BX-IDC2.54-2-NPZZ		
			.X±0.20	.X°±1°	审核 CHECK	2.54DC3-NP in H8.9 180μ PC3.2 L11.5 6T	页次 SHEET	1/1
			.XX±0.10	.XX°±0.5°	核准 APPROVAL	客户料号 CUTM.NO.		
					单位 UNITS			
					MM			