

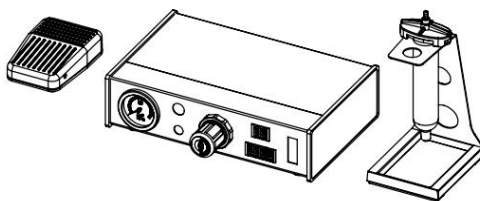

QUICK 982B Dispensing Controller

Instruction Manual



Thank you for purchasing our products. Please keep the instruction manual properly for future reference.

Contents

1. Safety Instructions.....	1
2. Overview.....	2
3. Product Characteristics.....	2
4. Product Specifications.....	3
5. Functional Descriptions.....	4
5.1. Dimensions.....	4
5.2. Part Descriptions.....	4
6. Installation.....	6
7. Adjust the Dispensing and Interval Time.....	7
8. Adjust the Vacuum Control.....	9
9. Tips for Dispensing.....	9
10. Troubleshooting.....	11
11. Circuit Diagram of Dispensing Controller.....	13
11.1. Components List.....	13
11.2. Circuit Diagram.....	14
12. Pneumatic System of Dispensing Controller	14
12.1. Components List.....	14
12.2. Pneumatic System Diagram.....	15

1.Safety Instructions



CAUTION

- During the installation and use of this product, all electrical safety regulations of the country and regions must be strictly observed.
- If the product does not work properly, please contact the supplier or our company, and do not disassemble or change the product in any way. We are not responsible for any problems caused by unauthorized maintenance or modification.



WARNING

- The product should be used away from places where there is magnetic interference.
- Don't install the product in a place where the surface is easy to shake or be impacted, as it may damage the product.
- Don't install the product in places where it may be exposed to rain or moisture.
- Don't use in flammable and explosive environments.
- The maximum pressure of the compressed air shall not exceed 0.7MPa, and the air source shall be kept dry.
- Avoid reversing the liquid barrel or placing it horizontally, which will cause the liquid to flow back into the air pipe and damage the internal components.
- Avoid exposing the dispensing controller to excessive moisture or corrosive air and liquid environment.
- When the it is not in use, please turn off the power to prolong its life.
- Please unplug the power cord when the product is not used for a long time.

2.Overview

This dispensing controller uses compressed air as the power source. By setting the air pressure value and pressure time, it ensures the dispensing volume is consistent each time.

The dispensing controller is widely applicable to red glue, yellow glue, epoxy resin, silica gel, lubricating oil, screw locking glue, quick-drying glue, flux or solder paste, etc. It is equipped with different sizes of needles according to the characteristics of glue and the requirements of dispensing volume to give full play to the functions of the dispensing controller.

3.Product Characteristics

- The time of each dispensing is controlled by timer, and the glue is dispensed regularly and quantitatively to ensure that the volume of each dispensing is consistent.
- By adjusting the pressure and selecting the appropriate time and nozzle, the volume of each dispensing and the dispensing time can be changed to meet different needs.
- Liquid or paste can be dispensed, such as red glue, yellow glue, epoxy gum, solder paste, silica gel, flux and so on.
- Pedal switch and manual control are available, with manual control it will be more suitable for standing operation.
- Various specifications of syringes and needle nozzles are available.
- Fully automatic dispensing controller is also available.

4.Product Specifications

Product model	982B
Voltage	AC 110V/220V
Power	12W
Dispensing mode	16 modes such as manual timing and auto timing can be set freely
Dispensing time	0.01s-99.99s adjustable
Interval time	0.1s-9.9s adjustable
Repeat stability	±0.05%
Minimum dispensing volume	0.01ml
Input air pressure	0.25MPa—0.7MPa
Output air pressure	0.01MPa—0.7MPa
Vacuum	>20KPa
Dimensions (L*W*H)	238×150×60mm
Weight	About 2.9kg

5. Functional Descriptions

5. 1. Dimensions

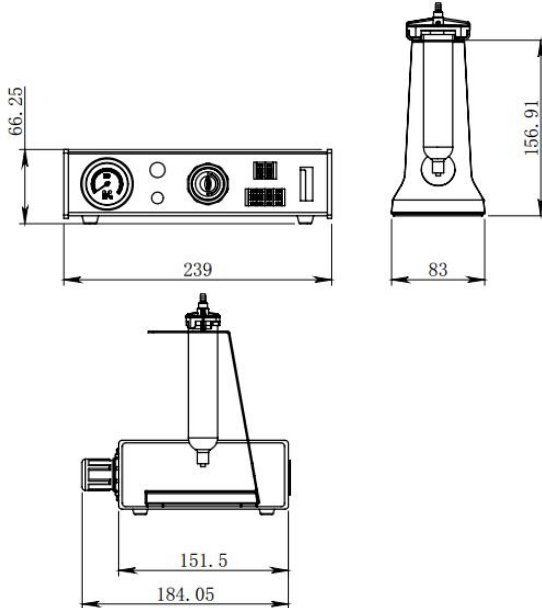

Unit: mm

5. 2. Part Descriptions

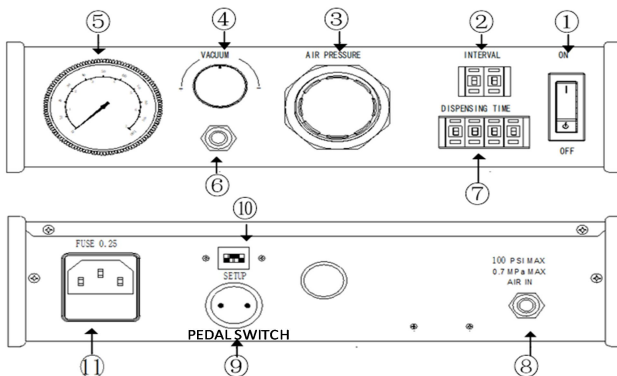

NO.	Part Descriptions	Function Descriptions
1	Power switch	Press "ON/OFF" to turn on/off.
2	Interval dial switch	Set the dispensing interval time.
3	Air pressure regulator	Adjust the air pressure
4	Vacuum control knob	Adjust the power of vacuum "suction back".
5	Barometer	Indicates the air pressure
6	Dispensing joint	Connector for dispensing air pressure output
7	Dispensing dial switch	Set the dispensing time and gap time
8	Air inlet pipe	Compressed air inlet.
9	Pedal switch	Trigger (pedal switch) to start the dispensing controller.
10	Mode setting switch	Select the dispensing mode
11	Power outlet	Provide power to the dispensing controller.

6.Installation

Please operate according to the following figure:

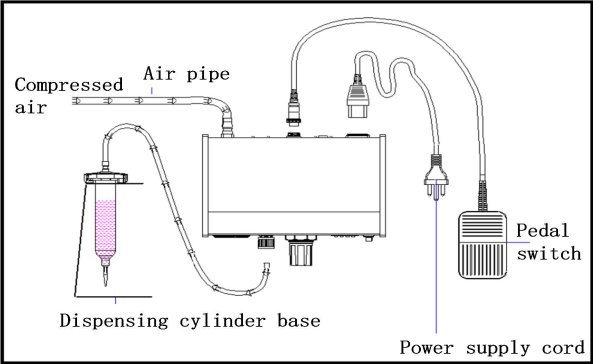
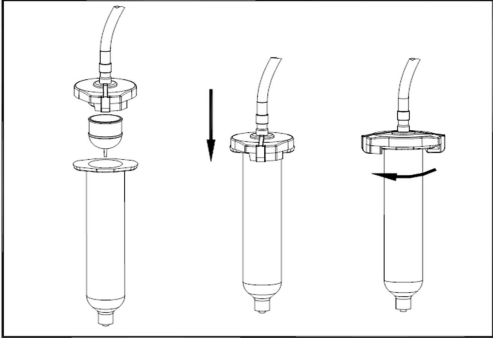

7.Adjust the Dispensing and Interval Time

The SETUP switch on the rear panel of the dispensing controller can be combined according to the following sheet:



NO.	Mode Switch Status				Function Descriptions
	S1	S2	S3	S4	
1	OFF	OFF	OFF	OFF	Step on the pedal switch to dispense, and release to stop dispensing.
2	ON	OFF	OFF	OFF	Trigger for one time, and regularly dispensing 1 time.
3	OFF	ON	OFF	OFF	Trigger for one time, and regularly dispensing 2 times.
4	ON	ON	OFF	OFF	Trigger for one time, and regularly dispensing 3 times.
5	OFF	OFF	ON	OFF	Trigger for one time, and regularly dispensing 4 times.
6	ON	OFF	ON	OFF	Trigger for one time, and regularly dispensing 5 times.
7	OFF	ON	ON	OFF	Trigger for one time, and regularly dispensing 6 times.
8	ON	ON	ON	OFF	Trigger for one time, and regularly dispensing 7 times.
9	OFF	OFF	OFF	ON	Trigger for one time, and regularly dispensing 8 times.
10	ON	OFF	OFF	ON	Trigger for one time, and regularly dispensing 9 times.

11	OFF	ON	OFF	ON	Trigger for one time, and regularly dispensing 10 times.
12	ON	ON	OFF	ON	Trigger for one time, and regularly dispensing 11 times.
13	OFF	OFF	ON	ON	Trigger for one time, and regularly dispensing 12 times.
14	ON	OFF	ON	ON	Trigger for one time, dispenses continuously and regularly, and then trigger again stops dispensing.
15	OFF	ON	ON	ON	Step on the pedal switch to dispense continuously and regularly, and release the pedal switch to stop dispensing.
16	ON	ON	ON	ON	Automatic dispensing continuously and regularly.

Note: Dispensing regularly refers to dispensing according to the set dispensing time and dispensing interval time.

Set the dispensing time (DISPENSING TIME):

Press the "+" and "-" on the four-position dial to adjust the setting range from 00.01 seconds to 99.99 seconds with a resolution of 0.01 seconds.

Set the interval time (INTERVAL):

Press "+" and "-" on the two-position dial to set the range from 0.1 second to 9.9 seconds with a resolution of 0.1 second.

8.Adjust the Vacuum Control

Adjust the vacuum control knob to prevent dispensing in the stop state.

9.Tips for Dispensing

- 1) As shown in FIG.1, hold the dispensing cartridge by hand for about 60° (or $\pm 20^\circ$).
- 2) After dispensing, move the needle as shown in FIG. 2.
- 3) It is not allowed to let the liquid flow back to the controller as shown in FIG. 3.
- 4) Method for changing the size of the dispensing point:
 - a) Increase or decrease dispensing time.
 - b) Increase or decrease air pressure.
 - c) Increase or decrease needle size.

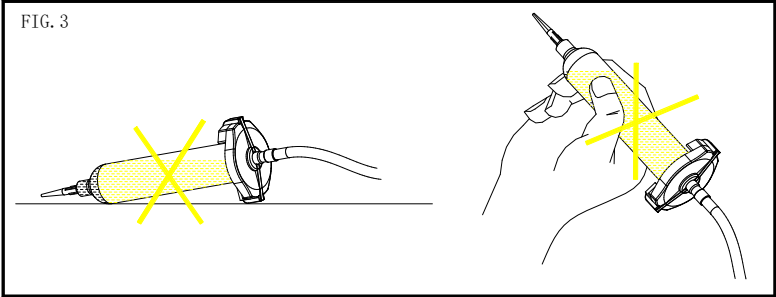
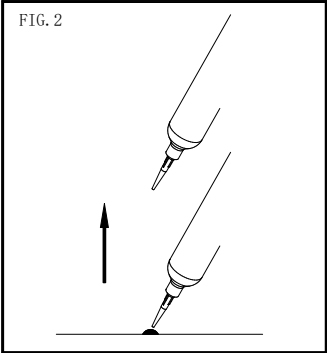
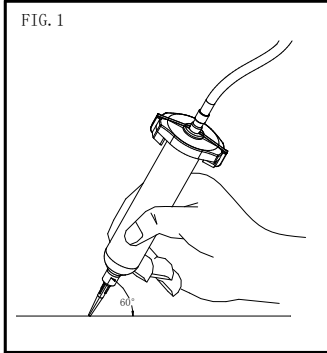

10.Troubleshooting

Error	Solution
No power	<ol style="list-style-type: none"> 1. Check the power socket and fuse. 2. Pull out the plug, remove the top cover, and check whether there is any looseness or short circuit in the dispensing controller.
There is power but the display light is not on	Replace the power switch.
There is power, the display light is on, but it cannot be operated	<ol style="list-style-type: none"> 1. Check the connection of pedal switch 2. Pull out the plug, remove the top cover, and check whether there is any looseness in the unit
There is power, the display light is on, but no glue dispensing	<ol style="list-style-type: none"> 1. Check the airflow supply and pressure meter, reset the regulator, remove the liquid barrel, and step on the pedal switch to check the air flow. 2. Check whether the spiral hose is blocked by sundries from the air compressor, clean and replace the spiral hose.
There is noise in the spiral hose	The voltage or air pressure is insufficient, or the spiral hose is not cleaned.
The fuse is damaged	<ol style="list-style-type: none"> 1. Check the fuse specification. 2. Pull out the plug, remove the top cover, and check whether there is short circuit in the unit.

<p>The glue dispensing volume is not consistent</p>	<ol style="list-style-type: none"> 1. Check whether the needle nozzle, liquid barrel and adjusting connector are blocked. 2. Check whether the bubbles in the liquid and the liquid concentration are consistent. 3. Check the pressure difference in the barometer.
<p>Glue dispensing is normal but there is no vacuum suck-back pressure</p>	<ol style="list-style-type: none"> 1. Check the vacuum pressure adjustment settings. 2. Check the are pressure setting (0.01-0.27 MPa).

11.Circuit Diagram of Dispensing Controller

11. 1. Components List

No.	Description
F1	0.25A Fuse
P1	Power Panel
P2	Control Panel
S1	Electromagnetic Valve
SW1	Power Switch
SW2	Pedal Switch
SW3	Time Setting Switch
SW4	Mode Switch(Encoder Switch)
TR1	Transformer 110V/24V
	Transformer 220V/24V
	Transformer 230V/24V

11. 2. Circuit Diagram

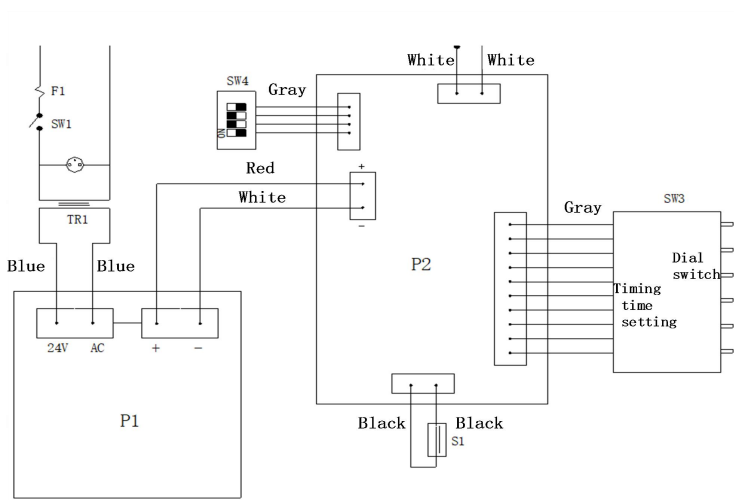

12. Pneumatic System of Dispensing Controller

12. 1. Components List

No.	Description
1	Electromagnetic Valve
2	Dispensing Socket
3	Barometer
4	Vacuum Regulator
5	Air Pressure Valve
6	Air Inlet Connection

12. 2. Pneumatic System Diagram

