

Description:

This N-Channel MOSFET uses advanced trench technology and design to provide excellent $R_{DS(on)}$ with low gate charge. It can be used in a wide variety of applications.

Features:

- 1) $V_{DS}=30V, I_D=12A, R_{DS(ON)}<12m\ \Omega @V_{GS}=10V$
- 2) Improved dv/dt capability
- 3) Fast switching
- 4) 100% EAS Guaranteed
- 5) Green Device Available.

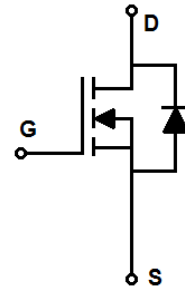
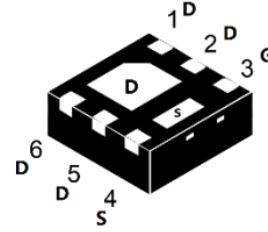

Package Marking and Ordering Information:

Part NO.	Marking	Package	Packing
RC012NG	C012N	DFN2*2-6	3000pcs/Reel

Absolute Maximum Ratings: ($T_C=25^\circ\text{C}$ unless otherwise noted)

Symbol	Parameter	Ratings	Units
V_{DS}	Drain-Source Voltage	30	V
V_{GS}	Gate-Source Voltage	± 20	V
I_D	Continuous Drain Current- $T_C=25^\circ\text{C}$	12	A
	Continuous Drain Current- $T_C=100^\circ\text{C}$	10	
I_{DM}	Drain Current – Pulsed ¹	48	A
P_D	Power Dissipation - $T_C=25^\circ\text{C}$	2.6	W
E_{AS}	Single pulse avalanche energy ²	20	mJ
T_J, T_{STG}	Operating and Storage Junction Temperature Range	-55 to +150	$^\circ\text{C}$

Thermal Characteristics:

Symbol	Parameter	Max	Units
$R_{\theta JA}$	Thermal Resistance, Junction to Ambient ³	48	$^\circ\text{C}/\text{W}$

Electrical Characteristics: ($T_C=25^{\circ}\text{C}$ unless otherwise noted)

Symbol	Parameter	Conditions	Min	Typ	Max	Units
Off Characteristics						
BV_{DSS}	Drain-Source Breakdown Voltage	$V_{GS}=0V, I_D=250\mu A$	30	---	---	V
I_{DSS}	Drain-Source Leakage Current	$V_{GS}=0V, V_{DS}=30V$	---	---	1	μA
I_{GSS}	Gate-Source Leakage Current	$V_{GS}=\pm 20V, V_{DS}=0A$	---	---	± 100	nA
On Characteristics						
$V_{GS(th)}$	Gate-Source Threshold Voltage	$V_{GS}=V_{DS}, I_D=250\mu A$	1	1.7	2.2	V
$R_{DS(on)}$	Drain-Source On Resistance ⁴	$V_{GS}=10V, I_D=10A$	---	9.2	12	m Ω
		$V_{GS}=4.5V, I_D=5A$	---	15	20	
Dynamic Characteristics						
C_{iss}	Input Capacitance	$V_{DS}=15V, V_{GS}=0V, f=1MHz$	---	810	---	pF
C_{oss}	Output Capacitance		---	111	---	
C_{rss}	Reverse Transfer Capacitance		---	86	---	
Switching Characteristics						
$t_{d(on)}$	Turn-On Delay Time	$V_{DD}=15V, V_{GS}=10V, R_G=3\Omega, I_D=5A$	---	6.3	---	ns
t_r	Rise Time		---	15.7	---	ns
$t_{d(off)}$	Turn-Off Delay Time		---	21	---	ns
t_f	Fall Time		---	4.2	---	ns
Q_g	Total Gate Charge	$V_{DS}=15V, V_{GS}=10V, I_D=5A$	---	17.8	---	nC
Q_{gs}	Gate-Source Charge		---	3.3	---	nC
Q_{gd}	Gate-Drain "Miller" Charge		---	3.5	---	nC
Drain-Source Diode Characteristics						
I_{SD}	Source drain current(Body Diode)	$V_D=V_G=0V$	---	---	12	A
V_{SD}	Source-Drain Diode Forward Voltage	$V_{GS}=0V, I_{SD}=12A$	---	---	1.2	V
T_{rr}	Reverse Recovery Time	$I_F=5A,$	---	10	---	ns
Q_{rr}	Reverse Recovery Charge	$di/dt=100A/us$	---	4.5	---	nc

Notes:

1. Repetitive Rating: Pulse Width Limited by Maximum Junction Temperature.
2. E_{AS} condition: Starting $T_J=25^\circ\text{C}$, $V_{DD}=15\text{V}$, $V_G=10\text{V}$, $R_G=25\text{ohm}$, $L=0.5\text{mH}$, $I_{AS}=9\text{A}$
3. $R_{\theta JA}$ is measured with the device mounted on a 1inch^2 pad of 2oz copper FR4 PCB
4. Pulse Test: Pulse Width $\leq 300\mu\text{s}$, Duty Cycle $\leq 0.5\%$.

Typical Characteristics: ($T_C=25^\circ\text{C}$ unless otherwise noted)

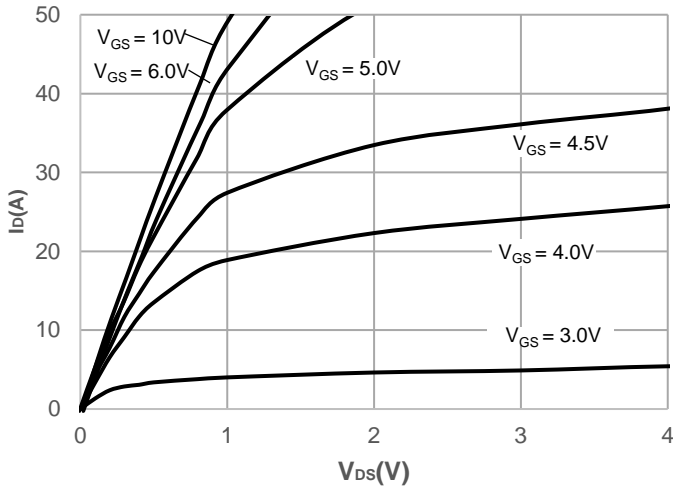

Figure 1: Output Characteristics

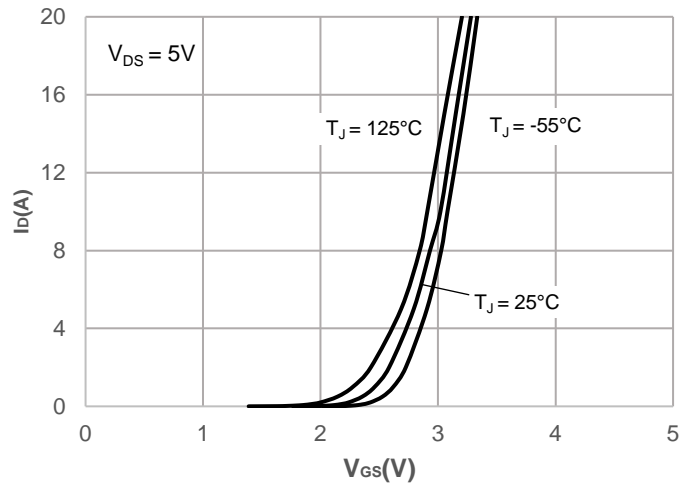

Figure 2: Typical Transfer Characteristics

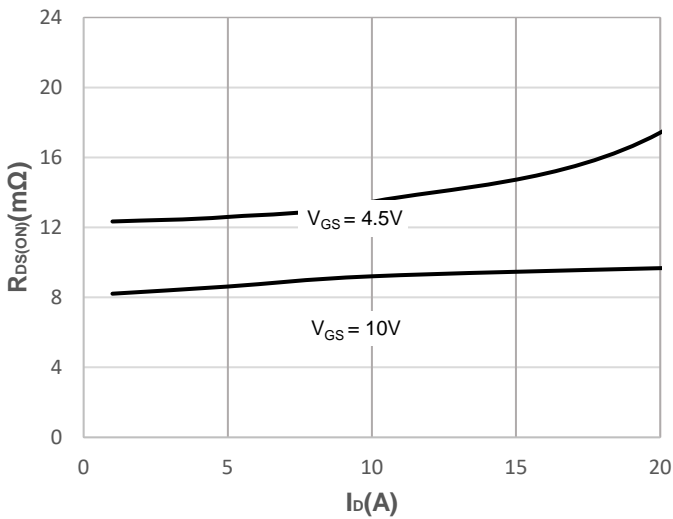

Figure 3: On-resistance vs. Drain Current

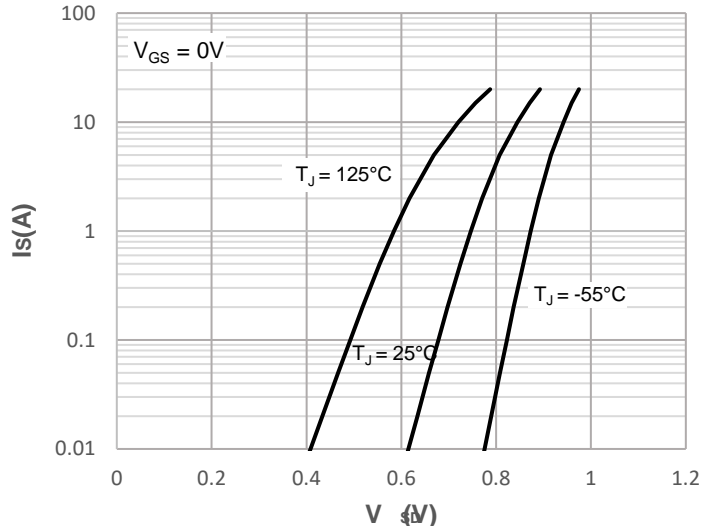

Figure 4: Body Diode Characteristics

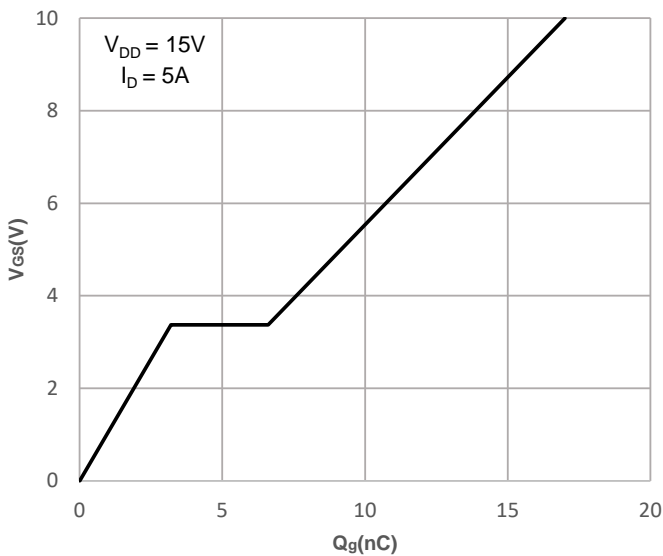

Figure 5: Gate Charge Characteristics

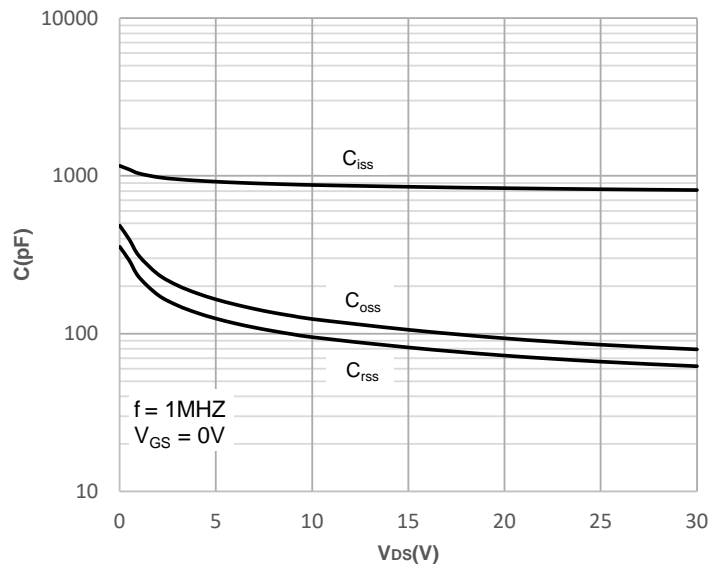

Figure 6: Capacitance Characteristics

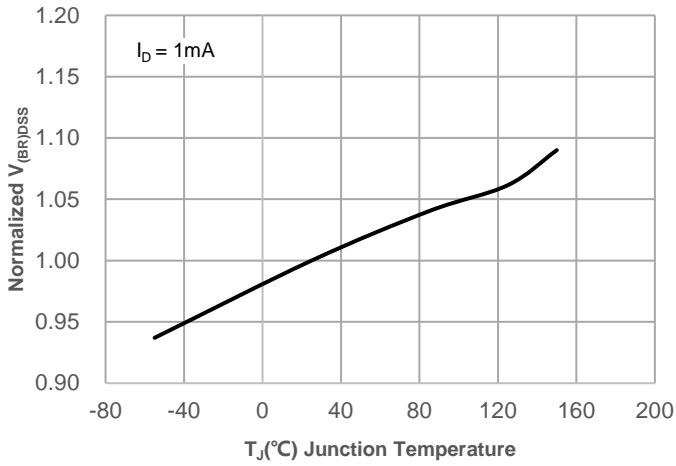

Figure 7: Normalized Breakdown voltage vs. Junction Temperature

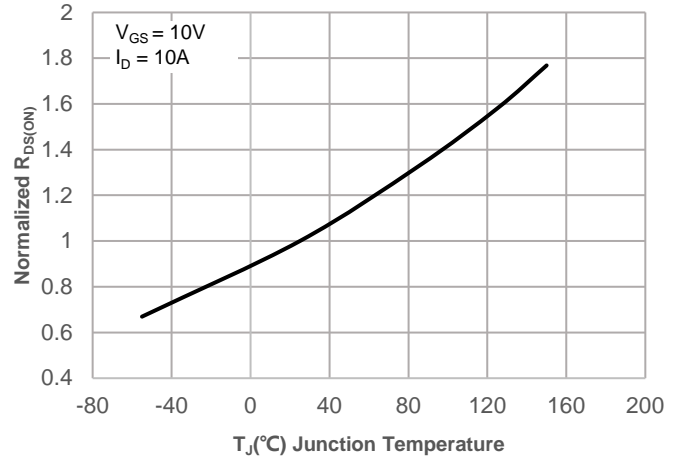

Figure 8: Normalized on Resistance vs. Junction Temperature

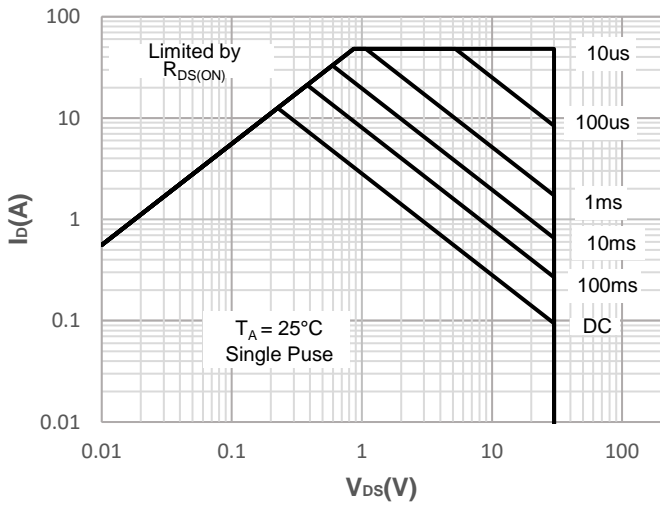

Figure 9: Maximum Safe Operating Area

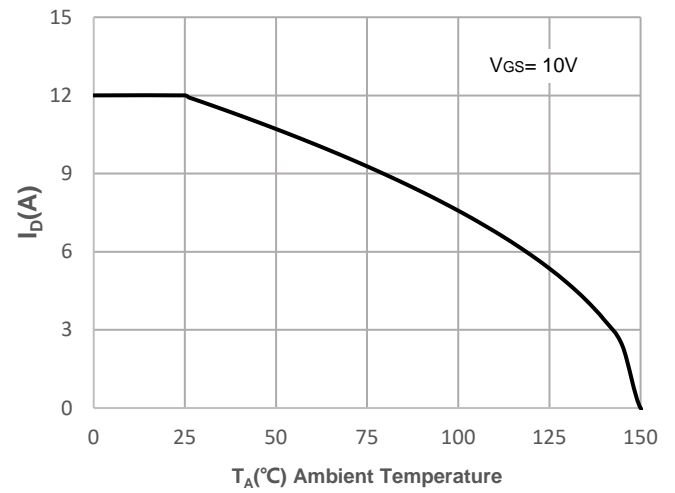

Figure 10: Maximum Continuous Drain Current vs. Ambient Temperature

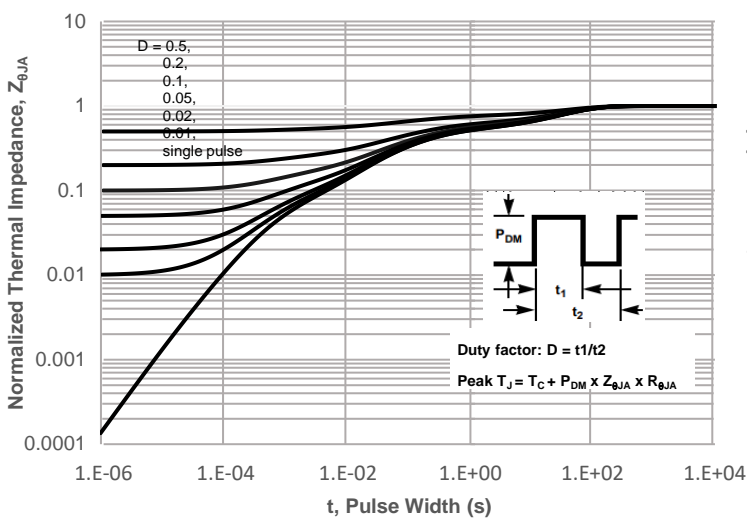

Figure 11: Normalized Maximum Transient Thermal Impedance

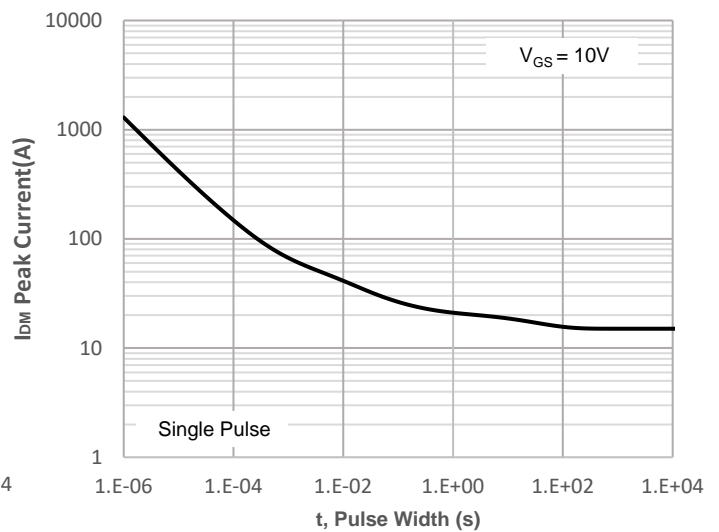
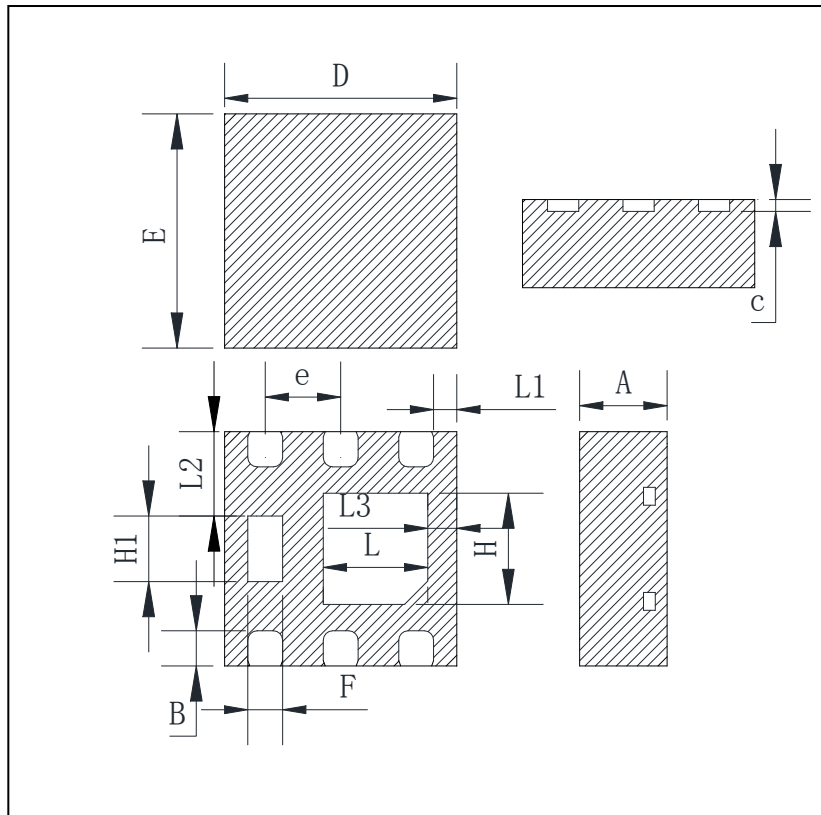

Figure 12: Peak Current Capacity

DFN2X2-6 Package Outline Data



Symbol	Min	Typ	Max
A	0.70	0.75	0.80
B	0.25	0.30	0.35
C	0.153	0.203	0.253
D	1.90	2.00	2.10
E	1.90	2.00	2.10
e	0.60	0.65	0.70
F	0.25	0.30	0.35
H	0.90	1.00	1.10
H1	0.50	0.60	0.65
L	0.80	0.90	1.00
L1	0.15	0.20	0.25
L2	0.60	0.70	0.80
L3	0.25	0.30	0.35

UNIT: mm

Marking Information:

①: Part NO.

②: Date Code (YWWG / R)

Y: Year Code , last digit of the year

WW : Week Code (01-53)

G/R: G(Green) /R(Lead Free)

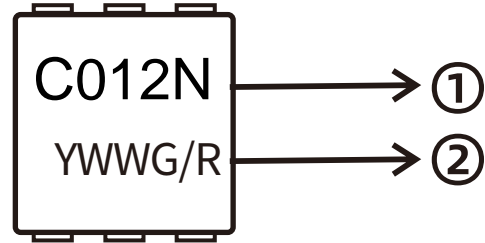

Previous Version

Version	Date	Subjects (major changes since last revision)
1.0	2024-07-27	Release of final version

Attention :

- Information furnished in this document is believed to be accurate and reliable. However, Shenzhen Doingter Semiconductor Co.,Ltd. assumes noresponsibility for the consequences of use without consideration for such information nor use beyond it.
- Information mentioned in this document is subject to change without notice, apart from that when an agreement is signed, Shenzhen Doingter complies with the agreement. Products and information provided in this document have no infringement of patents.
- Shenzhen Doingter assumes noresponsibility for any infringement of other rights of third parties which may result from the use of such products and information. This document supersedes and replaces all information previously supplied.  Is a registered trademark of Shenzhen Doingter Semiconductor Co., Ltd. Copyright © 2013 Shenzhen DoingterSemiconductor Co.,Ltd. Printed All rights reserved.