

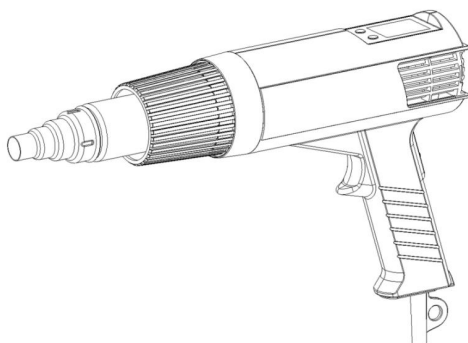

QUICK885W Hot Air Gun

Instruction Manual



Thank you for purchasing our products. Please keep the instruction manual properly for future reference.

Contents

1. Safety Instructions.....	1
2. Overview.....	2
3. Product Characteristics.....	2
4. Product Specifications.....	3
5. Functional Descriptions.....	4
5.1. Dimensions.....	4
5.2. Part Descriptions.....	5
5.3. Main Menu.....	6
6. Connection.....	7
7. Temperature Setup.....	7
8. Temperature Calibration.....	7
9. Grille Cover.....	8
10. Replacing the Heater.....	8
10.1. Steps of Removing the Heater.....	8
10.2. Steps of Replacing the Heater.....	9

1.Safety Instructions



CAUTION

- During the installation and use of this product, all electrical safety regulations of the country and regions must be strictly observed.
- The power supply must be disconnected when disassembling the product. Do not operate with power on.
- If the product does not work properly, please contact the supplier or our company, and do not disassemble or change the product in any way. We are not responsible for any problems caused by unauthorized maintenance or modification.



WARNING

- The product should be used away from places where there is magnetic interference.
- Don't install the product in a place where the surface is easy to shake or be impacted, as it may damage the product.
- Don't place the product in places where it may be exposed to rain or moisture.
- Don't use in flammable and explosive environments.
- Pay attention to the air outlet and its surroundings. High temperature operation, be careful of burns.
- Power supply should be turned off during breaks or after work to avoid safety accidents.
- Please keep the air outlet unblocked and ensure there is no obstruction.
- Please unplug the power cord when the product is not used for a long time.
- Check and maintain the product regularly. Do not use the product when it is damaged, especially when the power cord is damaged.

2.Overview

This hot air gun adopts dual eddy current brushless fan, high-power ceramic heater and closed-loop temperature control. It can be used in many occasions, such as circuit board repair, thermal shrinkage, drying, paint removal, glue removal, preheating, glue soldering, etc.

3.Product Characteristics

- Brushless motor, low noise, double vortex outflow wind, soft air volume.
- Advanced hot air heating technology, accurate and uniform temperature.
- LCD, digital temperature calibration.
- High power, rapid temperature rise, k-type sensor closed loop, accurate temperature control.
- Automatic cooling protection after shutdown, can prolong the service life of heater and make it safer.

4.Product Specifications

Model	885W	
Display	LCD (resolution: 1°C)	
Temperature Range	50~600°C	
Power Consumption	1400W	1800W
Voltage	AC 110V	AC 220V
Noise	<55dB	
Dimensions(L*W*H)	337*189.5*72mm	
Weight	About 1.0 kg	

5.Functional Descriptions

5. 1. Dimensions

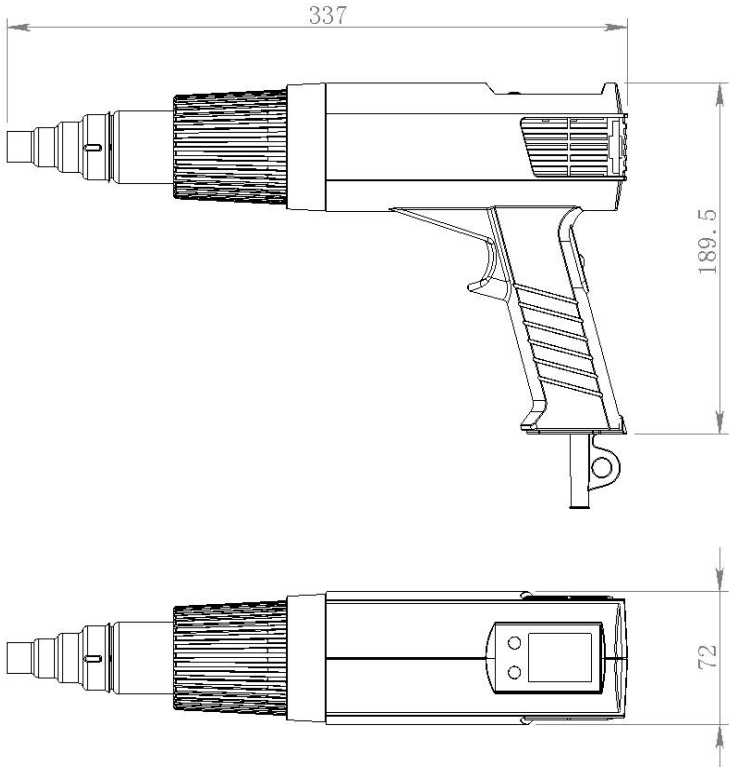

Unit: mm

5. 2. Part Descriptions

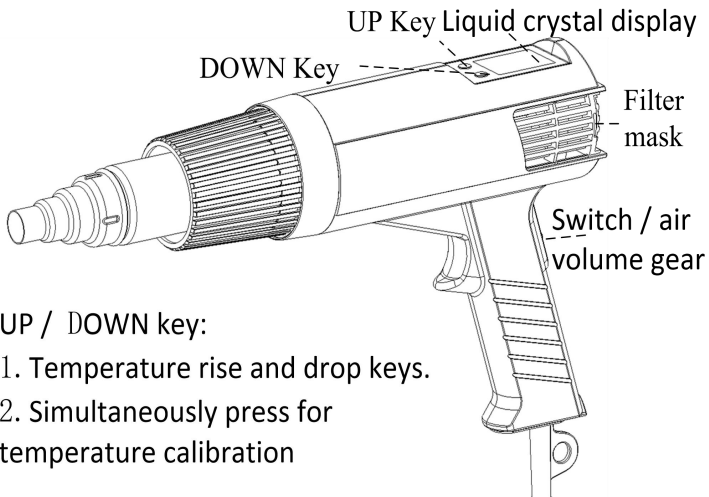

UP / DOWN key:

1. Temperature rise and drop keys.
2. Simultaneously press for temperature calibration

5. 3. Main Menu

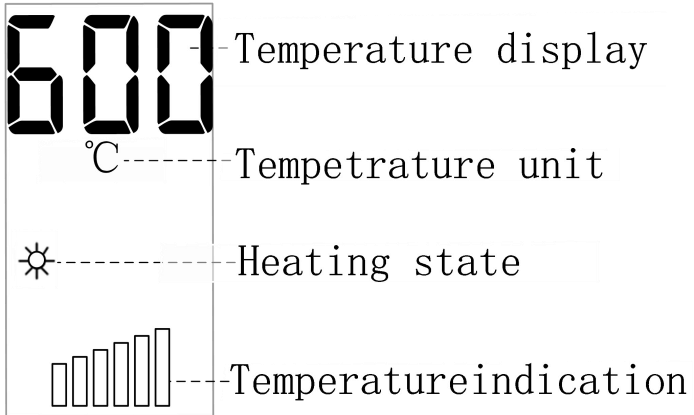

6.Connection

- 1) Insert the plug into the power socket.
- 2) Turn the power switch to the required gear and set the temperature (refer to 7, temperature setting).
- 3) Start working after the temperature is stable.
- 4) After the work is completed, the air volume dial is adjusted to gear 0, the air gun will cool down to below 100 °C and shut down automatically.

7.Temperature Setup

- 1) Press "UP" key and the temperature will rise. After releasing for at least 1 second, the set temperature will be saved.
- 2) Press "DOWN" key and the temperature will drop. After releasing for at least 1 second, the set temperature will be saved.

After replacing the heater, it is recommended to recalibrate the temperature of the hot air gun.

Calibrate the temperature with thermometer.

8.Temperature Calibration

- 1) After startup, set the working temperature and adjust the air volume to gear III. When the temperature is stable, test the air outlet temperature with thermometer and record the reading value.
- 2) Press “UP” & “DOWN” keys for 2 seconds, then "CAL" will appear on the display interface to enter the temperature calibration interface.
- 3) Press "UP" or "DOWN" key to adjust the temperature to the measured value.
- 4) Press “UP” or “DOWN” key for 2 seconds. If "OK" is displayed, the calibration is successful.

9.Grille Cover

- 1) Place a slotted screwdriver in the gap of the grille at the bottom of the hot air gun, and pull out the grille backward in the direction of the grille guide. It can be cleaned with a brush or rinsed with clean water and then dried. (Do not use solvents for cleaning)
- 2) Put the cleaned grille into the grille guide column and push forward along the guide direction of the grille.

10.Replacing the Heater

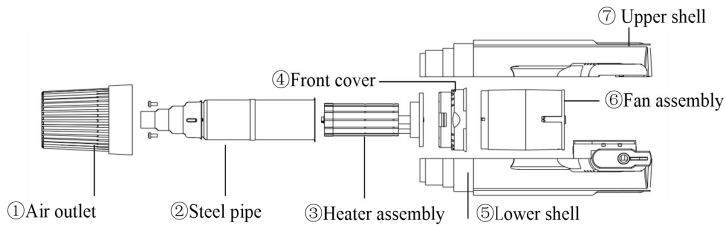

10. 1. Steps of Removing the Heater

- 1) Unscrew the ① Air outlet at the front-end of the handle.
- 2) Remove the five screws of the ⑦ Upper shell and remove the ⑤ Lower shell.
- 3) Unplug the socket of the ③ Heater assembly.
- 4) Take out the ③ Heater assembly, ② Steel pipe and ⑥ Fan assembly from the ⑦ Upper shell.
- 5) Remove the four screws in the ④ Front cover and remove the ④ Front cover.
- 6) Pull out the ③ Heater assembly from the ② Steel pipe.

10. 2. Steps of Replacing the Heater

- 1) Put the ③Heater assembly into the ②Steel pipe and fix the ④Front cover on the ②Steel pipe with four screws. Pass the heater and the green grounding core out of the ②Steel pipe and the notch of the ④Front cover.
- 2) Install the ⑥Fan assembly into the ④Front cover and fix the heater on the ⑥Fan assembly with adhesive tape. Then install the ③Heater assembly, ②Steel pipe and ⑥Fan assembly in the original position of the ⑦Upper shell.
- 3) Insert the socket into the heater.
- 4) Close the ⑤⑦Upper and lower shells of the machine, and then tighten five screws.
- 5) Tighten the anti-scald sheath.
- 6) After the heater is replaced, please do the following measurements:

Resistance value of heater (black and white cord): 220V: $29\ \Omega$ ($\pm 10\%$)

110V: $9\ \Omega$ ($\pm 10\%$)

Resistance value of sensor (blue cord): $< 2.5\ \Omega$

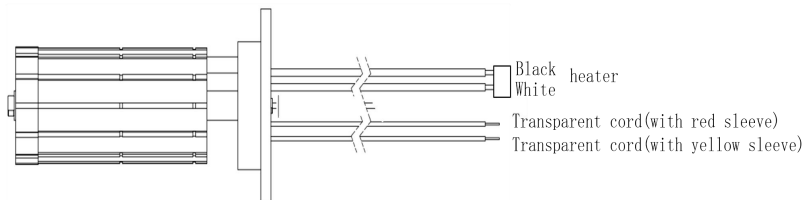

7)After replacing the heater, recalibrate the temperature (refer to temperature calibration).

Note: Do not scald the cord when replacing the heater, and do not solder the cord for a long time.

Warranty Card

●The warranty period of this product is calculated from the date of Purchase. During the warranty period, if the product breaks down during normal use, show the original warranty card and enjoy free service in the authorized repair company(or our company). Please keep the purchase certificate and this warranty card and show it before maintenance.

●During the warranty period, the following repairs need to be paid:
a.Unable to offer valid warranty card or certificate;
b.The purchase date, sales company and other items are not completely filled or the warranty card is altered;
c.Damage caused by failure to follow the use methods and precautions in the manual;
d.Damage caused by disassembly, repair and modification of products without authorization of the manufacturer;
e.Replacement of vulnerable and consumable parts.

●All items of the warranty card shall be completely filled in by the agent or user to obtain a 12-month warranty period.
●Please keep this warranty card properly It will not be re-offered after.

QUICK INTELLIGENT EQUIPMENT
CO., LTD.
ADD: NO.11, FengXiang Road, Wujin
High-Tech Industrial Development
Zone, Jiangsu, China
TEL: 86-519-86225678
FAX: 86-519-86558599
POSTCODE: 213167
WEBSITE: www.quick-global.com

Warranty Card

Type: _____

Model No.: _____

Serial No.: _____

Delivery Date: _____

Warranty File Card

Type: _____

Model No.: _____

Serial No.: _____

Delivery Date: _____

Address : _____

Postcode: _____

Telephone: _____

Contact Person: _____

QUICK INTELLIGENT EQUIPMENT CO., LTD.

ADD: NO.11, FengXiang Road, Wujin
High-Tech Industrial Development Zone,
Jiangsu, China

TEL: 86-519-86225678

FAX: 86-519-86558599

POSTCODE: 213167

WEBSITE: www.quick-global.com

