

REVISIONS					
REV.	ECN NO.	LOCATION	DESCRIPTION	DATE	DESIGN
A1	N/A			2025.05.09	
A2	ECN-P-2025110801	(A2)X6		2025.11.08	

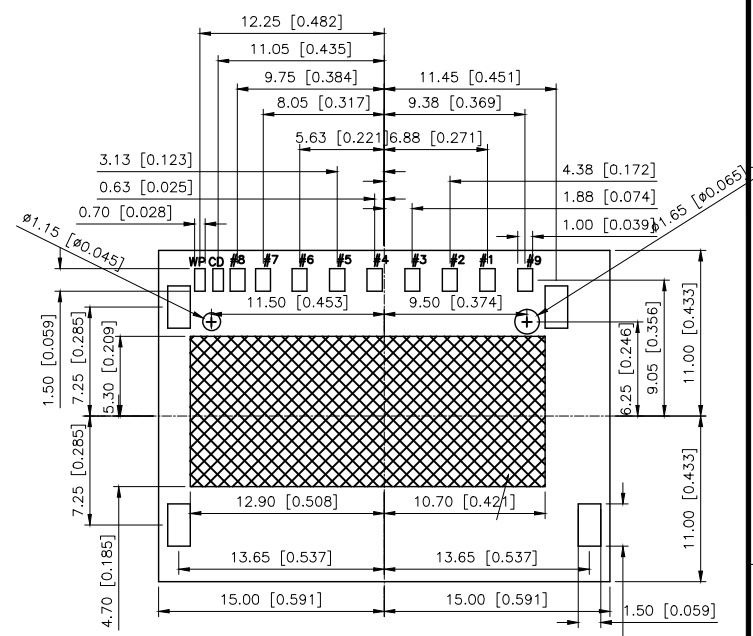
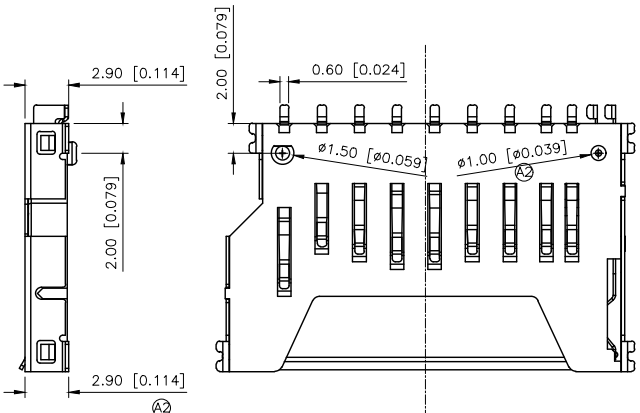
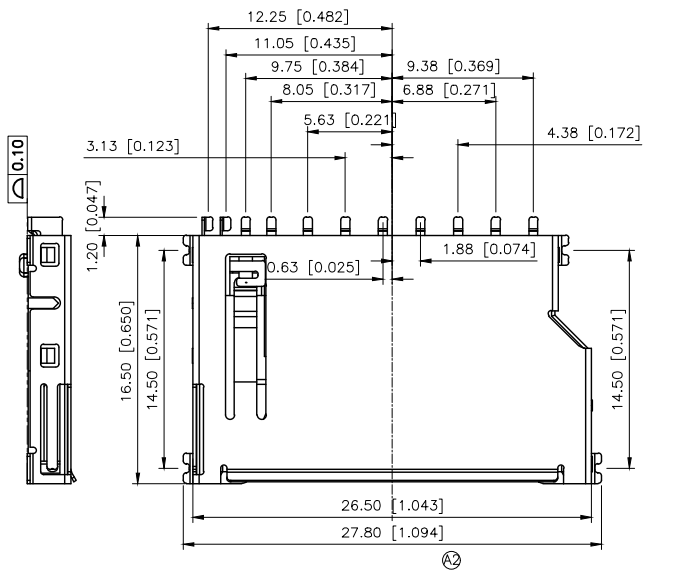

P.C.B. LAYOUT  
(TOLERANCE: ±0.05)

NOTES:  
 ELECTRICAL CHARACTERISTICS:  
 CONTACT CURRENT RATING: 0.5AMPERS  
 DIELECTRIC WITHSTANDING VOLTAGE: AC/DC 200V  
 INSULATION RESISTANCE: 1000MΩ MIN.  
 CONTACT RESISTANCE: 50~100mΩ  
 ENVIRONMENTAL:  
 OPERATING TEMPERATURE: -20°C~+60°C  
 MECHANICAL CHARACTERISTICS:  
 CONTACT INSERTION FORCE: 1.00KGF MAX  
 CONTACT SEPARATION FORCE: 0.20KGF MIN.  
 MEATERIAL:  
 INSULATION: HI-TEMP THERMOPLASTICS UL 94V-0

XKSD-001-X  
 1:SPCC 5:BRASS

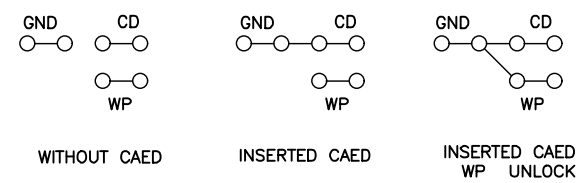
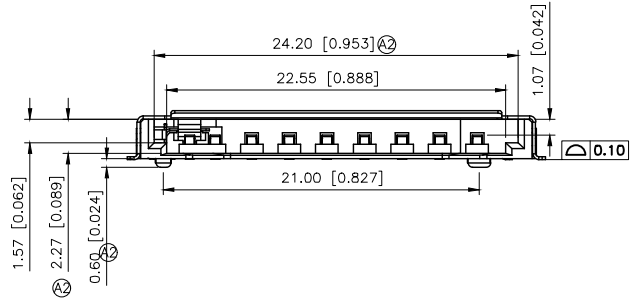

ITEM	PAPT NAMF	QTY	MATERIAL	FINISHING
③	Shell	1	SPCC/BRASS	
②	Terminal	11	COPPER ALLOY	
①	Housing	1	LCP UL 94V-0	WHITE

PIN NO.	NAME	DESCRIPTION
1#	CD/DAT3	CARD DETECT
2#	CMD	COMMAND
3#	VSS1	GROUND
4#	VDD	POWEER
5#	CLK	CLACK
6#	VSS2	GROUND
7#	DATO	DATE I/O
8#	DAT1	DATE I/O
9#	DAT2	DATE I/O

PIN NO.	NAME
1	DAT3
2	CMD
3	Vss1
4	VDD
5	CLK
6	Vss2
7	DATO
8	DAT1
9	DAT2

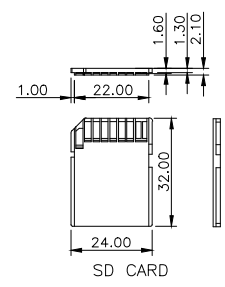

AuGLAR	±5°
X.	±0.40
X.x	±0.30
X.xx	±0.20
X.xxx	±0.15
UNSPECIFIED TOLERANCES	



DESIGN	
CHECKED	
APPROVED	

VIEW:	MODEL TYPE: SD CARD CONN
UNIT: mm/in	PART NO.: XKSD-001-X
SIZE: A4	DWG NO.: