

"\*" Pivot Dimension

RoHS Component

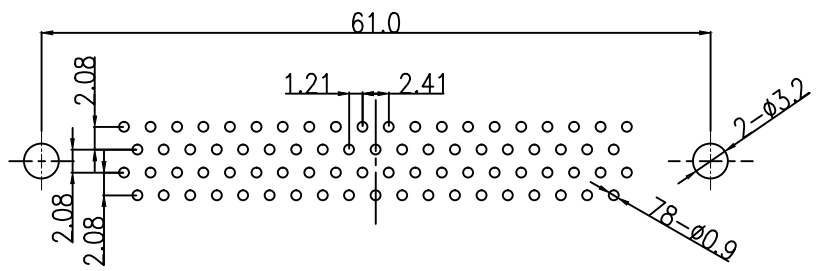
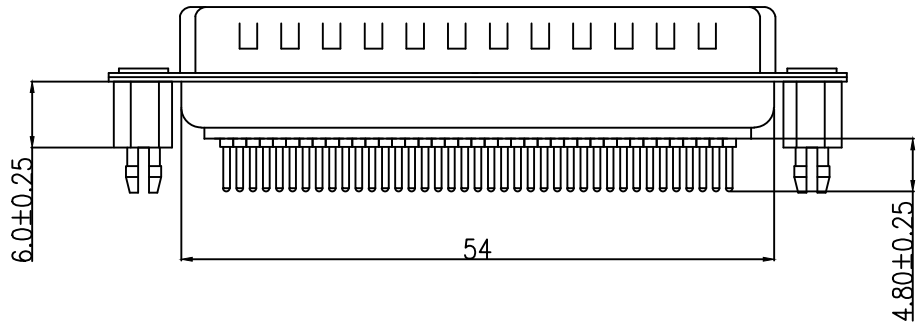
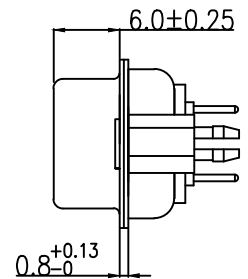
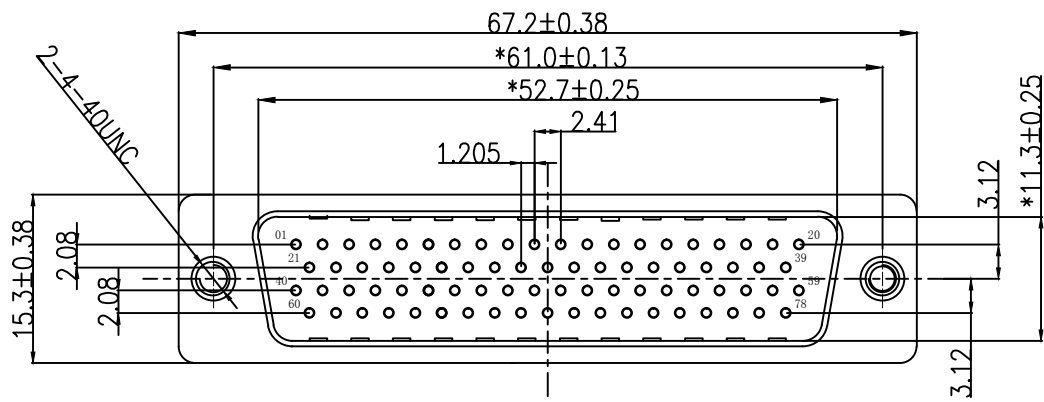

PCB LAYOUT

NOTICE :

- ELECTRICE:
  - DIELECTRIC RATING: 300V
  - CONTACT CURRENT RATING: 3AMP
  - CONTACT RESISTANCE: 15mΩ MAX.
  - INSULATION RESISTANCE: 1000MΩ MIN. AT 500V DC
  - DIELECTRIC STRENGTH: 500V AC RMS FOR 1MINUTE
  - OPERATION TEMPERATURE: -55°C ~125°C
- MATERIAL:
  - INSULATOR: PBT+30% G. F (UL94V-0)
  - CONTACT: COPPER ALLOY
  - CONTACT PLATED: GOLD FIASH OVER NICKEL
  - SHELL: SPCC
  - SHELL PLATED: NICKEL/TIN

# 浙江创都电子科技有限公司

<b>TOLERANCE:</b> XX ±0.38 XXX ±0.25 XXXX ±0.13 X.* ±5°    X.X* ±2°	DRAWN BY :	DATE :	PART NAME:	
			2009.11.21	HDP 78 公直焊板式铆6.0鱼叉QH
	CHECKED BY :	DATE :	DRAW NO.	HDP-G-78P-ZC-YCLS
		2009.11.25	PART NO.	
	APPROVED BY :	DATE :	REMARK	
		2009.11.25	MOLD NO.	
UNIT: mm [inch] SCALE:1:1    SIZE: A4				