

RoHS Complied

CUSTOMER P/N:

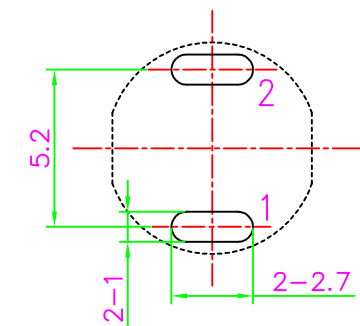
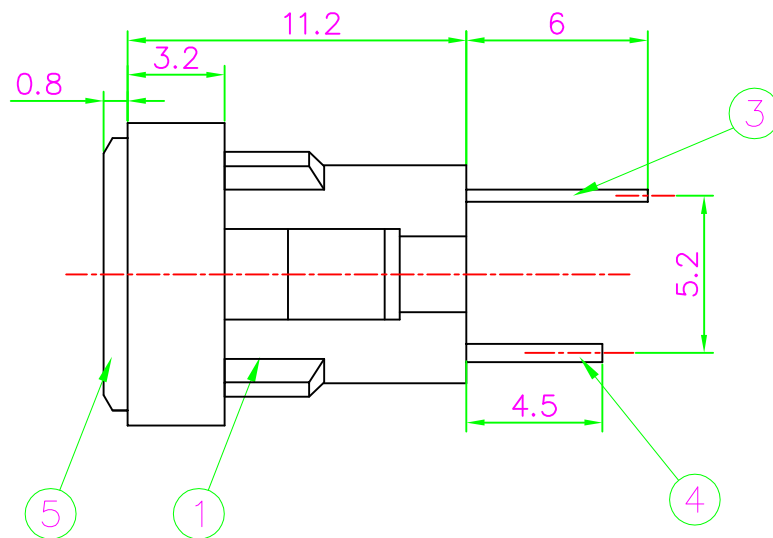
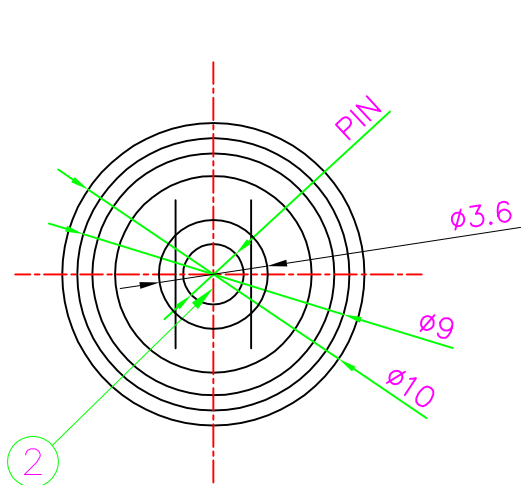

PCB HOLES(TOP VIEW)  
NOTE: GENERAL TOLERANCE: ±0.1mm

PIN	Ø1.3	Ø1.7	Ø2.0	Ø2.5
APPD				

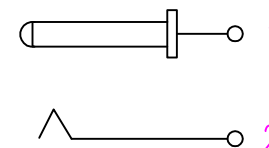

TERMINAL NO.

SCHEMATIC

SPECIFICATION

- 1.Rating : DC 30V 0.5A;
- 2.Contact resistance: ≤0.03Ω;
- 3.Insulation resistance: ≥100MΩ (DC500V);
- 4.Withstand voltage: 500VAC ;
- 5.Insertion and extraction force: 3-20N;
- 6.life test: 5,000 cycles;
- 7.Practical temperature rang: -40~+75℃;

NO.	PART NAME	TER'NO.	QTY.	MATERIAL	REMARK
⑤	AXLE SLEEVE		1	H59	Ni-PLATED
④	CENTER PIN TERMINAL	1	1	BRASS T=0.5	SuSb-PLATED
③	TIP SPRING	2	1	BRASS T=0.4	SuSb-PLATED
②	CENTER PIN		1	H59	CuSn-PLATED
①	HOUSING		1	PA	BLACK

MARK	DESCRIPTION	DATE	REVISED	APPROVED	UNSPECIFIED TOLERANCE
△ X					ANGULAR ±5'
△ X					63 < L ±0.5
△ X					16 < L ≤ 63 ±0.4
△ X					4 < L ≤ 16 ±0.3
					L ≤ 4 ±0.2

DSND	DATE	SCALE: 1:1	MODEL TYPE:
CHKD	DATE	VIEW:	DC POWER JACK
APVD	DATE	UNIT: mm	PART NO. DC-022BAKK-2.0AU

浙江创都电子科技有限公司

REVISION A/0