

"\*" Pivot Dimension

RoHS Component

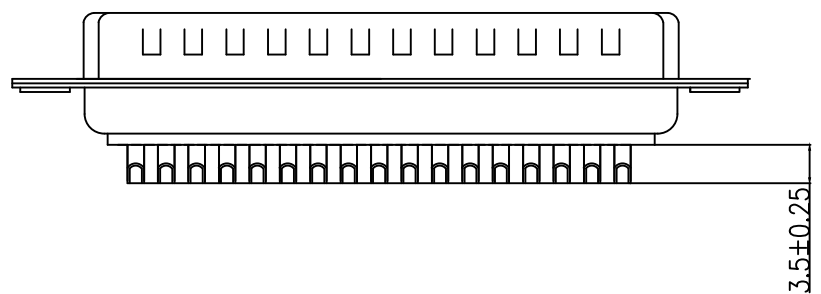
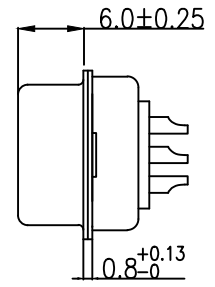
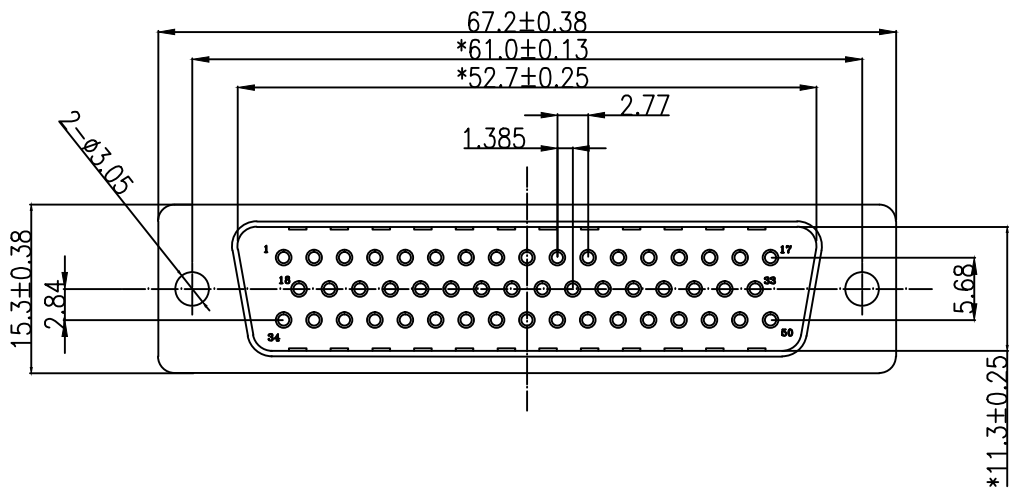

NOTICE :

- ELECTRICE:
  - DIELECTRIC RATING: 300V
  - CONTACT CURRENT RATING: 5AMP
  - CONTACT RESISTANCE: 15mΩ MAX.
  - INSULATION RESISTANCE: 1000MΩ MIN. at 500V DC
  - DIELECTRIC STRENGTH: 500V AC RMS for 1Minute
  - OPERATION TEMPERATURE: -55C° ~125C°
- MATERIAL:
  - INSULATOR: PBT+30% G. F(UL94V-0)
  - CONTACT: COPPER ALLOY
  - CONTACT PLATED:GOLD FIASH OVER NICKEL
  - SHELL: SPCC
  - SHELLPLATED:NICKEL/TIN

# 浙江创都电子科技有限公司

<b>TOLERANCE:</b> XX ±0.38 XXX ±0.25 XXXX ±0.13 X° ±5°    XX° ±2°	DRAWN BY :	DATE :	PART NAME:	
			2009.11.21	HDB 50P 公焊线式传统铆合0W
 <b>UNIT: mm [inch]</b> <b>SCALE:1:1    SIZE: A4</b>	CHECKED BY :	DATE :	DRAW NO.	DB-G-50P-HX-GK
			2009.11.25	PART NO.
	APPROVED BY :	DATE :	REMARK	
		2009.11.25	MOLD NO.	