

REV.	DESCRIPTION	DRAWN	CHECKED	APPROVED
A	NEW RELEASE	6/10/15		

- 备注:
- 电性说明:
 - 1.1 接触阻抗: 25毫欧最大
 - 1.2 耐压: AC 500V
 - 1.3 绝缘阻抗: 1000兆欧最小
 - 1.4 额定电流: 3A
 - 环境特性:
 - 2.1 工作温度: -40~+105° C
 - 材料:
 - 3.1 端子: 铜 半金锡
 - 3.2 外壳: 铁 镀锌
 - 3.3 Z字片: 铜 镀锡
 - 3.4 螺丝: 铜 镀锌
 - 3.5 胶芯: PBT, 黑色, 阻燃

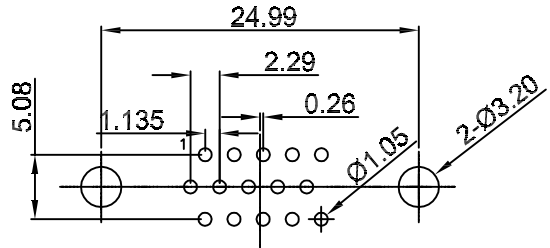
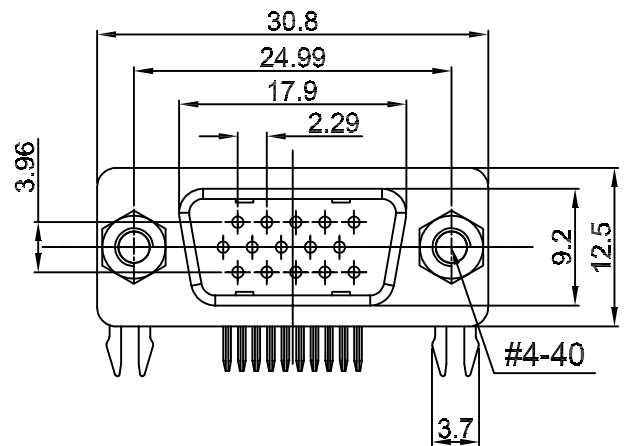
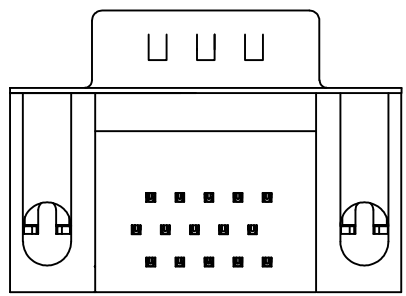
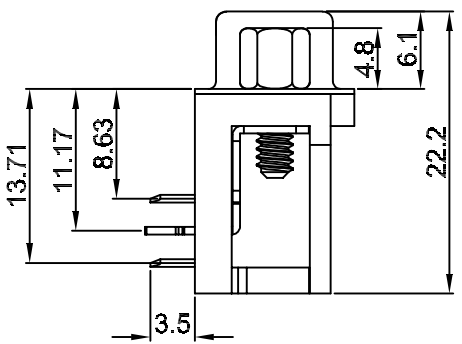

PCB板孔尺寸参考
公差: ±0.05

GENERAL TOLERANCE		ANGLE TOLERANCE	
X.	±0.60	X.	±5°
.X	±0.38	.X	±3°
.XX	±0.25	.XX	±2°
DRAWING TYPE	CUSTOMER		
SCALE	1:1	SHEET	1 OF 1
DRAWING NO.	SUB-1038-01		

L&X 深圳市连欣科技有限公司

PROJECTION UNITS SHEET SIZE	PART NO: Xddb-M1518-0938	
		TITLE: VGA-DB 15PIN 公座卧式3排脚DIP 带螺母
	mm A4	SERIES: DS1038 SERIES