

REV.	Q'TY	ECN. NO.	APR.	DATE

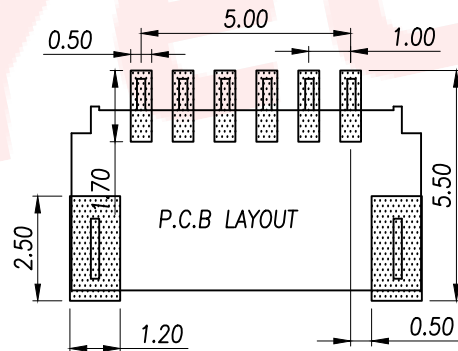
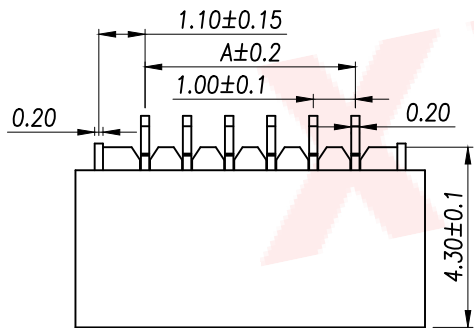
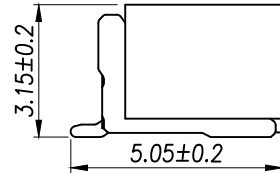
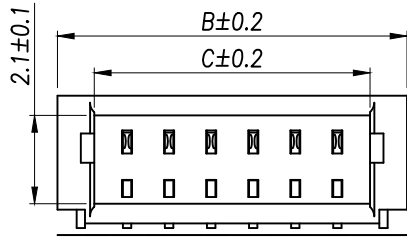
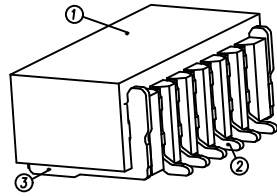

Part No	Pin	A	B	C
XY-1.0-2PWB-BD	2	1.00	4.35	2.60
XY-1.0-3PWB-BD	3	2.00	5.35	3.60
XY-1.0-4PWB-BD	4	3.00	6.35	4.60
XY-1.0-5PWB-BD	5	4.00	7.35	5.60
XY-1.0-6PWB-BD	6	5.00	8.35	6.60
XY-1.0-7PWB-BD	7	6.00	9.35	7.60
XY-1.0-8PWB-BD	8	7.00	10.35	8.60
XY-1.0-9PWB-BD	9	8.00	11.35	9.60
XY-1.0-10PWB-BD	10	9.00	12.35	10.60
XY-1.0-11PWB-BD	11	10.00	13.35	11.60
XY-1.0-12PWB-BD	12	11.00	14.35	12.60
XY-1.0-13PWB-BD	13	12.00	15.35	13.60
XY-1.0-14PWB-BD	14	13.00	16.35	14.60
XY-1.0-15PWB-BD	15	14.00	17.35	15.60
XY-1.0-16PWB-BD	16	15.00	18.35	16.60
XY-1.0-20PWB-BD	20	19.00	22.35	20.60

NOTES:

- 1.BASE: LCP
- 2.PIN: Brass
- 3.Solder Tab: Brass

SPECIFICATIONS:

- 1.Spacing: 1.0
- 2.Voltage Rating: 50V AC DC
- 3.Current Rating: 1A AC DC
- 4.Insulation Resistance: 100MΩ Min
- 5.Contact Resistance: 30mΩ Max
- 6.Withstanding voltage: 250V AC 1/Minute
- 7.Temperatuer Range: -40℃ ~+ 85℃

DIMENSION IN mm		厦门市辛译精密电子有限公司 Xiamen XinYi Xyecomm Electronics Co.,Ltd		
TOLERANCE UNLESS OTHERWISE SPECIFIED		TITLE: WAFER 1.00 封装		
.X±0.2	X.*± 5°	APR. Alex	DWG NO. XY-1.0-NPWB-BD	
.XX±0.1	.X.*± 3°	CHK. Jack	PROJ.  CUSTOMER DRAWING	
.XXX±0.05	.XX.*± 1°	DRA. Can	SIZE A4	SCALE 1:1 SHEET 1/1 REV. A