

NOTE:

- MATERIAL SPECIFICATION:
  - HOUSING: HIGH TEMPERATURE RESISTANT PLASTIC, UL94 V-0. (PA9T)
  - TERMINAL: COPPER ALLOY (C18150)
  - MID PLATE: STAINLESS STEEL (SUS301)
  - INNER SHELL: STAINLESS STEEL (SUS304)
  - COVER SHELL: STAINLESS STEEL (SUS304)
- PLATING SPECIFICATION:
  - TERMINAL:
    - Ni 50u" MIN. UNDER PLATED OVER ALL.
    - Au 3u" PLATED ON THE FUNCTIONAL AREA OF CONTACT.
    - Au G/F ON THE SOLDER AREA OF CONTACT.
  - INNER SHELL & COVER SHELL:
    - Ni 30u" MIN. UNDER PLATED OVER ALL.
  - MID PLATE:
    - CLEAR ONLY
- MECHANICAL PERFORMANCE,
  - INSERTION FORCE: 0.5~2.0kgf.
  - REMOVAL FORCE: 0.8kgf~2.0kgf.
  - DURABILITY: 10000 CYCLES.
- ELECTRICAL PERFORMANCE,
  - VOLTAGE RATING: 5V  
CURRENT RATING: 5A
  - LLCR:
    - VBUS & GND PINS AND OTHER PINS: 40mA/PIN MAX.
    - LLCR MAX. CHANGE OF ALL PINS: 10mA.
  - INSULATION RESISTANCE: 100MΩ MIN
  - DIELECTRIC WITHSTAND VOLTAGE, AC 100V FOR 1 MINUTE.
- ENVIRONMENTAL PERFORMANCE:
  - OPERATING TEMPERATURE: -40°C~+85°C.
- IR REFLOW:
  - THE PEAK TEMPERATURE ON THE BOARD SHALL BE MAINTAINED FOR 10 SECONDS AT 260°C.

制图 DRAWN	变更内容 DESCRIPTION	日期 DATE	GENERAL TOLERANCE		制图 DRAWING	EMMA	料号 PART NO.	BX-TYPEC-CBM16-CH16	版本 REV.	A										
			.X±0.30	X'±10°							审核 CHECK	EVA	品名 TITLE	USB CF 16PIN (L=7.0) SINK 1.6MM WITH COVER	页次 SHEET	1/1				
			.XX±0.20	.X'±8°													核准 APPROVAL	JADE	客户料号 CUTM.NO.	
			.XXX±0.10	.XX'±5°																
<b>Bossie (博锡)</b>																				

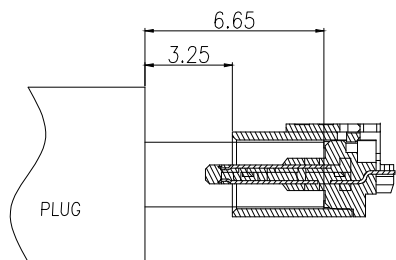

AFTER MATING

USB TYPE-C PIN ASSIGNMENTS

PIN NUMBER	SIGNAL NAME	PIN NUMBER	SIGNAL NAME
A1	GND	B12	GND
A4	VBUS	B9	VBUS
A5	CC1	B8	SBU2
A6	Dp1	B7	Dn2
A7	Dn1	B6	Dp2
A8	SBU1	B5	CC2
A9	VBUS	B4	VBUS
A12	GND	B1	GND

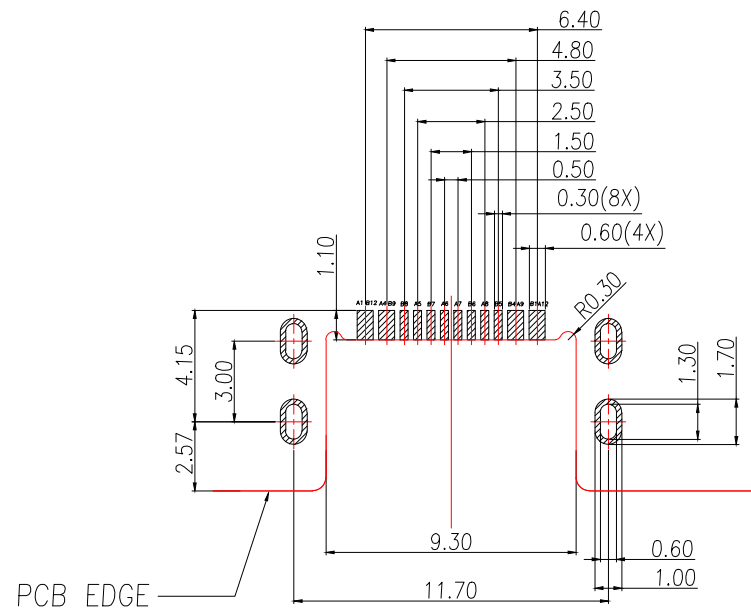

RECOMMENDED PCB LAYOUT(TOP VIEW)  
THICKNESS 0.60MM;DEFAULT TOLERANCE:±0.05

制图 DRAWN	变更内容 DESCRIPTION	日期 DATE	GENERAL TOLERANCE		制图 DRAWING	EMMA EVA JADE	料号 PART NO.	BX-TYPEC-CBM16-CH16	版本 REV.	A
			.X±0.30	X'±10°	审核 CHECK		品名 TITLE	USB CF 16PIN (L=7.0) SINK 1.6MM WITH COVER	页次 SHEET	1/1
			.XX±0.20	.X'±8°	核准 APPROVAL		客户料号 CUTM.NO.			
			.XXX±0.10	.XX'±5°	单位 UNITS		比例 SCALE	1:1	<b>Bossie (博锡)</b>	

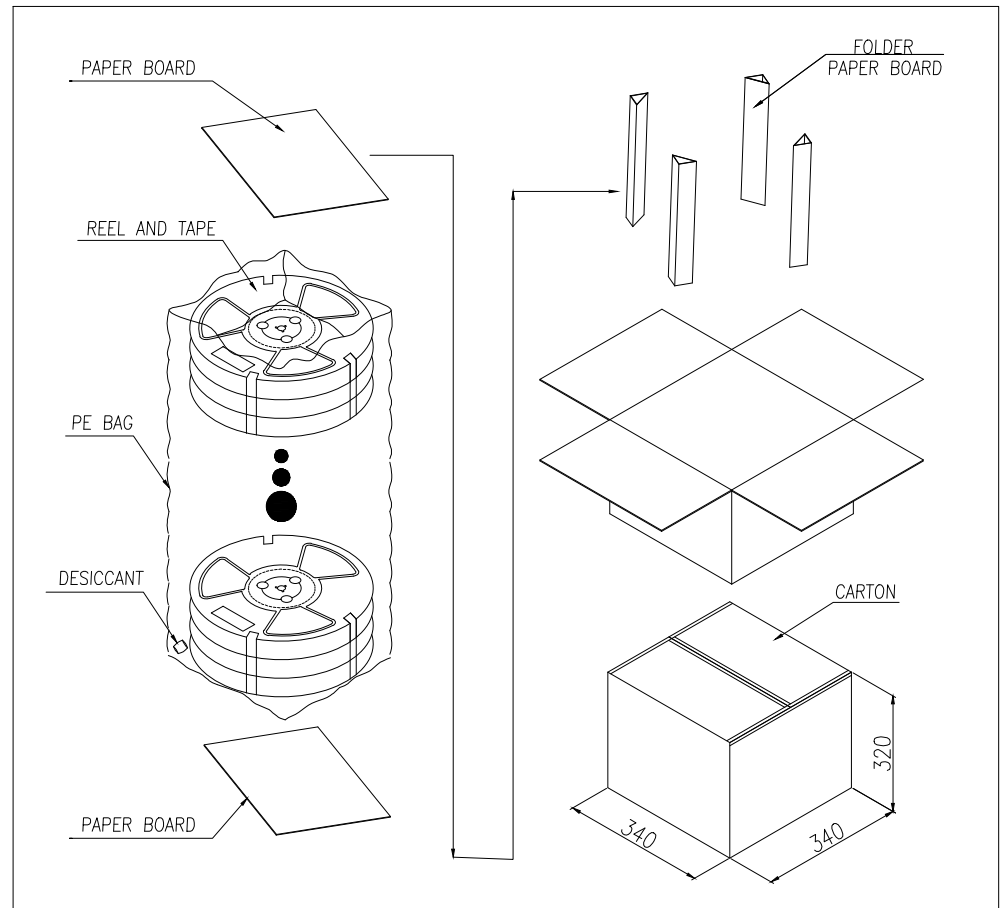
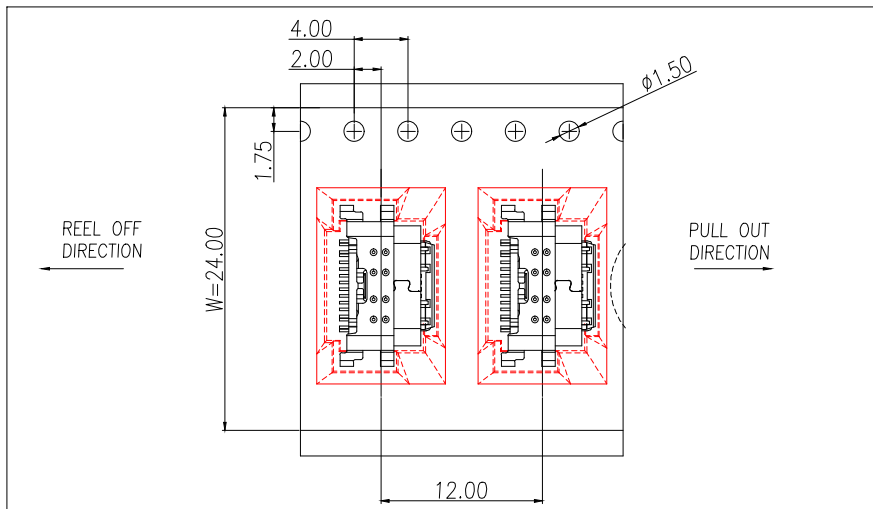
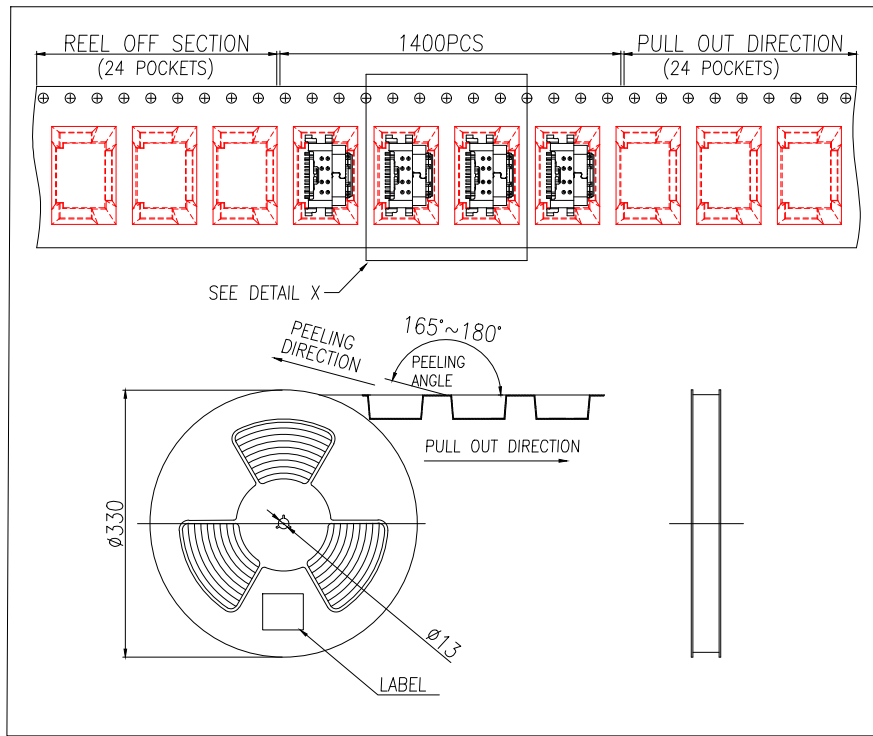

	REEL	CARTON
CONNECTOR (PCS)	1400	14000

制图 DRAWN	变更内容 DESCRIPTION		日期 DATE	GENERAL TOLERANCE		制图 DRAWING	EMMA			
				.X±0.30	X.*±10°		审核 CHECK	EVA		
				.XX±0.20	.X.*±8°			核准 APPROVAL	JADE	
				.XXX±0.10	.XX.*±5°				单位 UNITS	MM

料号 PART NO.	BX-TYPEC-CBM16-CH16	版本 REV.	A
品名 TITLE	USB CF 16PIN (L=7.0) SINK 1.6MM WITH COVER	页次 SHEET	1/1
客户料号 CUTM.NO.			
<b>Bossie (博锡)</b>			