

REV	ECN. NO.	DESC.	APPD.
A	WE210901	新版发行	LWW 210904

NOTES: (Unless otherwise specified)

1. Dimension shall be interpreted per ANSI Y14.5M.
2. Materials:
Insulator material: LCP, UL 94V-0; Color: Natural.
Contact material: Brass.
3. Current Rating: 0.5A .
4. Voltage Rating: 50V AC.
5. Working Temperature: -40°C ~ +105°C.
6. Harmful material should be compliant to doc. standards.
7. Product number matrix: 5001-BAP 0877-**MR-00-B

Standby
PACKING: R: REEL
MALE
PIN
MATING HEIGHT: 77-7.7H
0.8BTB
JM CONN BTB CONNECTOR SERIES

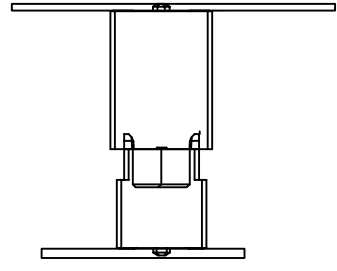
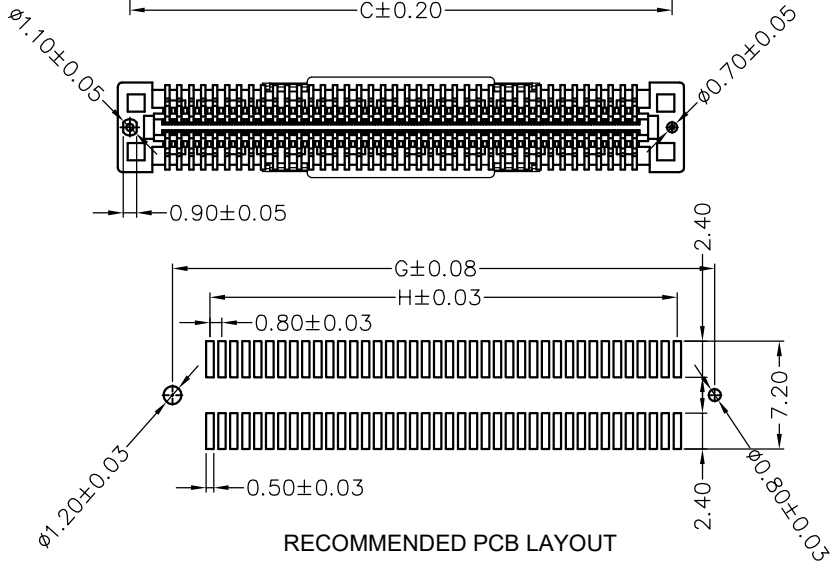
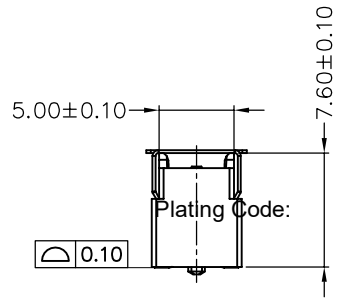
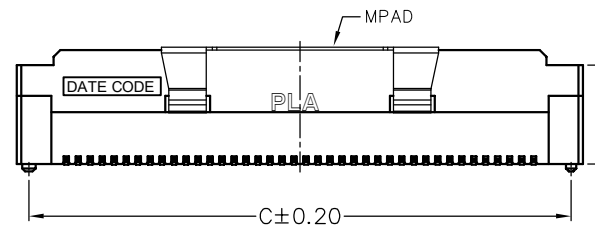
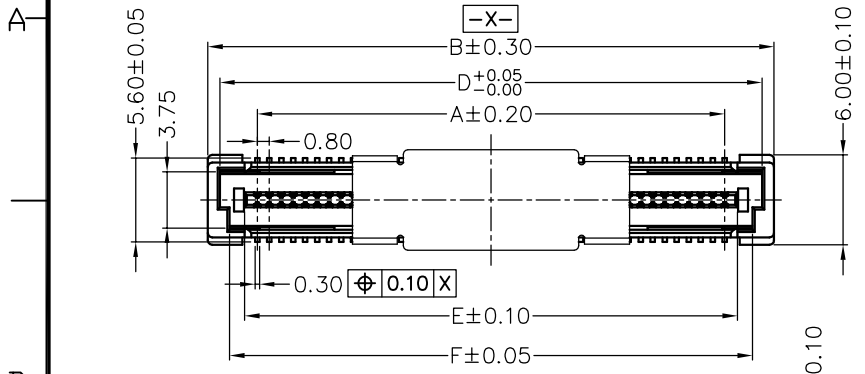

CIRCUITS	DIM.A	DIM.B	DIM.C	DIM.D	DIM.E	DIM.F	DIM.G	DIM.H
40	15.20	21.80	20.20	20.20	16.90	18.90	20.20	15.20
50	19.20	25.80	24.20	24.20	20.90	22.90	24.20	19.20
60	23.20	29.80	28.20	28.20	24.90	26.90	28.20	23.20
80	31.20	37.80	36.20	36.20	32.90	34.90	36.20	31.20
100	39.20	45.80	44.20	44.20	40.90	42.90	44.20	39.20
120	47.20	53.80	52.20	52.20	48.90	50.90	52.20	47.20
140	55.20	61.80	60.20	60.20	56.90	58.90	60.20	55.20
160	63.20	69.80	68.20	68.20	64.90	66.90	68.20	63.20
180	71.20	77.80	76.20	76.20	72.90	74.90	76.20	71.20
200	79.20	85.80	84.20	84.20	80.90	82.90	84.20	79.20

X.± 0.30	.X± 0.25	.XX± 0.20	NAME<INTENDED USE>: 0.8mm BTB PLUG.	东莞市文章济美电子有限公司
X.*± 3'	.X.*± 2'	.XX.*±	PART NO.<INTENDED USE>: 5001-BAP0877-**MR-00-B	TITLE: CUSTOMER DRAWING
UNITS: mm	DATE: 2021-9-04	MAT'L	APPD:	DWG NO.: 600-0000-0407
			CHKD:	SCALE SHEET REV N/A 1/1 A
			DR:	