

未注公差/General tolerances(mm)											
0	>3	>10	>18	>30	>50	>80	>120	>180	>250	>315	>400
~3	~6	~18	~30	~50	~80	~120	~180	~250	~315	~400	>500
±0.12	±0.18	±0.26	±0.31	±0.37	±0.57	±0.80	±0.93	±1.05	±1.15	±1.60	±2.20

REV	ECN	DESCRIPTION	DRFT	DATE

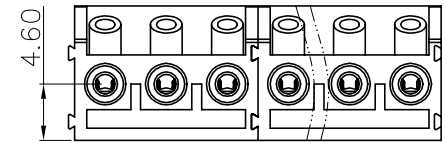
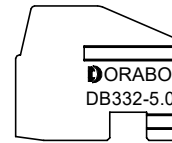
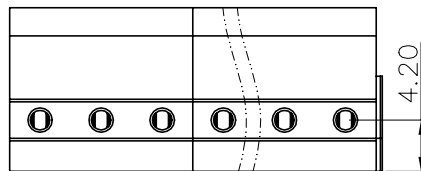
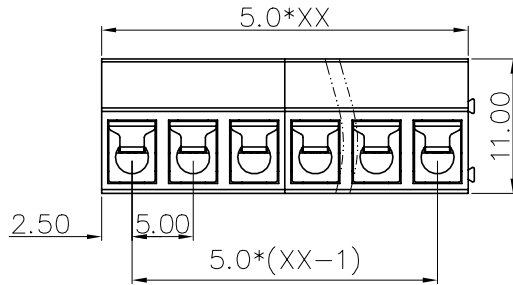
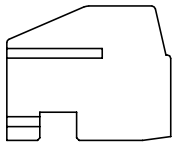
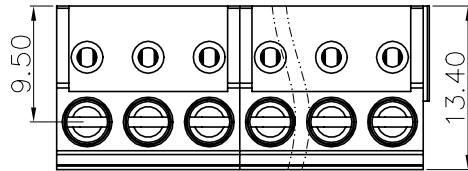

DB332 — 5.0 — XXP — C — S/P
 (Series No.) (Pitch) (Poles) Slotted/Phillips

(Color):GN:(Green), BK:(Black), BU:(Blue), RD:(Red), GY:(Gray)
 OG:(Orange), WT:(White), YL:(Yellow), CR:(Clear)

UL 标准/UL Standard:	B	C	D
额定电压/电流/Rated Voltage(V)/Current(A)	300/10	/	300/10
IEC 标准/IEC Standard:			
过压类别/Overvoltage Category/污染等级/Pollution Degree	III/3	III/2	II/2
额定电压/电流/Rated Voltage(V)/Current(A)	250/12	320/12	400/12
额定脉冲电压(Rate Impulse Voltage(KV)	4	4	4
螺丝扭矩/Torque Tightening(N·m/Lb.in)	M2.5	0.5N·m/3.54Lb.in	
线径范围(硬线和软线)/Wire Range(rigid and flexible)(mm ² /AWG)	0.2~1.5/28~16		
间距/Pitch(mm)/线数范围/Poles	5.0/XX=02~16P		
剥线长度/Stripping length(mm)	5-6		
使用温度范围/Operating temperature(°C)	-40~+105		
符合RoHS环保要求/Conform to RoHS	Yes		

Cage	Copper alloy	Ni Plated
Screw	Steel	Zn Plated
Conductor	Copper alloy	Sn Plated
Insulator	PA66	UL94V-0
NAME OF PART	MATERIAL	NOTES

MAT NO.:	/	NINGBO DORABO ELECTRICAL CO., LTD	
STATUS:	/	DB332-5.0-XXP-C-S	
APPD: MARK	2024.03.20	NAME:	
CHKD: MARK	2024.03.20	DRAWING NO.:	/
DRFT: MARK	2024.03.20	REV	M1
SIZE: A4	mm (inch)	TYPE: CUSTOMER_DRAWING	SCALE: SHEET 1/1