

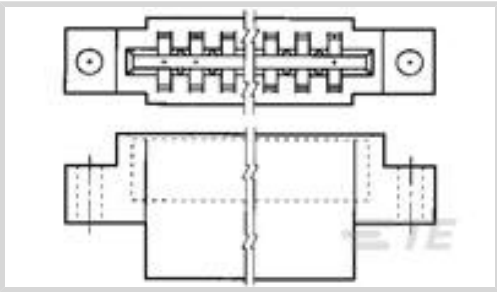

Connectors > PCB Connectors > Wire-to-Board Connectors > Wire-to-Board Connector Assemblies & Housings



Connector Product Type: **Housing**

Connector & Housing Type: **Receptacle**

Connector System: **Wire-to-Board**

Number of Positions: **18**

Centerline (Pitch): **3.96 mm [.156 in]**

Features

Product Type Features

Connector Product Type	Housing
Connector & Housing Type	Receptacle
Connector System	Wire-to-Board
Connector & Contact Terminates To	Printed Circuit Board

Configuration Features

Number of Dual Positions	18
Number of Positions	18
Number of Rows	2

Body Features

Primary Product Color	Black
-----------------------	-------

Contact Features

Contact Current Rating (Max)	5 A
------------------------------	-----

Termination Features

Termination Method to Wire & Cable	Crimp
------------------------------------	-------

Mechanical Attachment

Strain Relief	Without
PCB Mount Retention	Without
Panel Mount Feature Type	Mounting Ears



Connector Mounting Type	Board Mount
Housing Features	
Housing Material	Polyester GF
Centerline (Pitch)	3.96 mm[.156 in]
Dimensions	
	.75 in
Usage Conditions	
Operating Temperature Range	-55 – 105 °C[-67 – 221 °F]
Operation/Application	
Circuit Application	Power & Signal
Industry Standards	
Glow Wire Rating	Standard Part - Not Glow Wire
UL Flammability Rating	UL 94V-0
Packaging Features	
Packaging Quantity	200
Packaging Method	Carton
Product Compliance	
For compliance documentation, visit the product page on TE.com>	
EU RoHS Directive 2011/65/EU	Compliant
EU ELV Directive 2000/53/EC	Compliant
China RoHS 2 Directive MIIT Order No 32, 2016	No Restricted Materials Above Threshold
EU REACH Regulation (EC) No. 1907/2006	Current ECHA Candidate List: JUNE 2023 (235) Candidate List Declared Against: JAN 2022 (223) Does not contain REACH SVHC
Halogen Content	Not Low Halogen - contains Br or Cl > 900 ppm.
Solder Process Capability	Not applicable for solder process capability

Product Compliance Disclaimer

This information is provided based on reasonable inquiry of our suppliers and represents our current actual knowledge based on the information they provided. This information is subject to change. The part numbers that TE has identified as EU RoHS compliant have a maximum concentration of 0.1% by weight in homogenous materials for lead, hexavalent chromium, mercury, PBB, PBDE, DBP, BBP, DEHP, DIBP, and 0.01% for cadmium, or qualify for an exemption to these



limits as defined in the Annexes of Directive 2011/65/EU (RoHS2). Finished electrical and electronic equipment products will be CE marked as required by Directive 2011/65/EU. Components may not be CE marked. Additionally, the part numbers that TE has identified as EU ELV compliant have a maximum concentration of 0.1% by weight in homogenous materials for lead, hexavalent chromium, and mercury, and 0.01% for cadmium, or qualify for an exemption to these limits as defined in the Annexes of Directive 2000/53/EC (ELV). Regarding the REACH Regulation, the information TE provides on SVHC in articles for this part number is based on the latest European Chemicals Agency (ECHA) 'Guidance on requirements for substances in articles' posted at this URL: <https://echa.europa.eu/guidance-documents/guidance-on-reach>

Compatible Parts

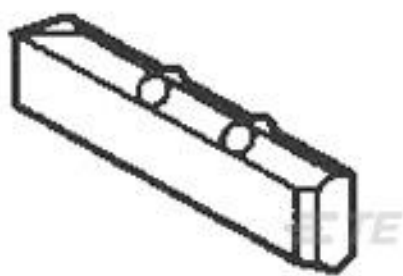

TE Part # 583274-1
KEYING PLUG

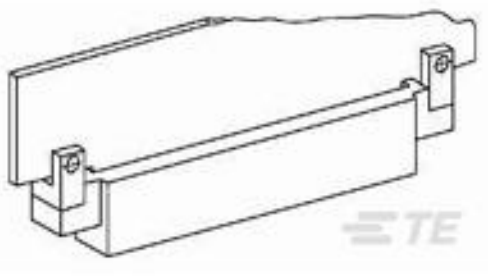

TE Part # 5-531250-4
CARD EDGE BOARD RETAINER LF

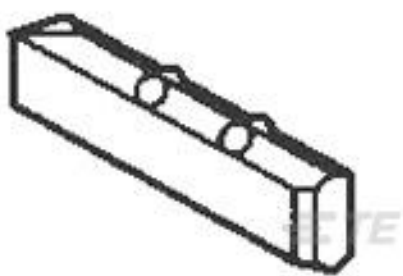

TE Part # 583274-3
KEYING PLUG

Also in the Series | AMP Twin-Leaf



Insertion & Extraction Tools(1)



Wire-to-Board Connector Assemblies
& Housings(27)



Wire-to-Board Connector Contacts(15)

Customers Also Bought



TE Part #640250-7
07P SL156 HSG W/LCK RAMP NATL



TE Part #208979-2
CONV OUTLET ASSY (BLACK)



TE Part #770090-1
06P .093 COMM P&S PLUG HSG



TE Part #640254-1
KEYING PLUG .045 SQ PST CONN



TE Part #62050-2
110 FASTON REC 20-16 AWG NPST

TE Part #61280-2
BUTTON CONTACT 20-16 AWG BR

TE Part #770095-1
09P .093 COMM P&S PLUG

TE Part #2-87456-5
30 MODIV HSG COMP DR .100CL

TE Part #840156-000
CG95LPM12-30X12/1

TE Part #2-1419106-0
27E488=SOCKET

Documents

Product Drawings
TW-LF CRP HSG 18 POS
English

Product Specifications
Product Specification
English
Product Specification
English

Instruction Sheets
Instruction Sheet (U.S.)
English

Agency Approvals
UL
English