

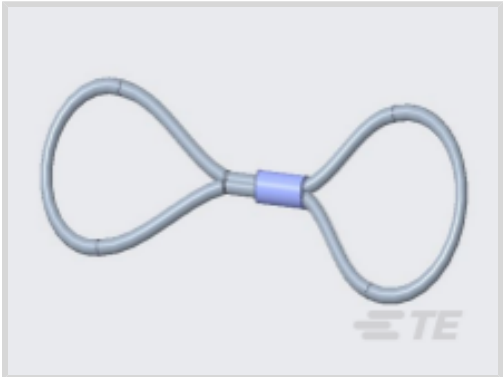

Connectors > Automotive Connectors > Automotive Connector Accessories > Other Automotive Connector Accessories



Automotive Connector Accessory Type: **Cap**

Primary Product Material: **Rubber**

Primary Product Color: **Black**

Operating Temperature Range: **55 – 125 °C [-67 – 257 °F]**

Features

Product Type Features

Automotive Connector Accessory Type	Cap
-------------------------------------	-----

Body Features

Primary Product Material	Rubber
Primary Product Color	Black

Usage Conditions

Operating Temperature Range	55 – 125 °C[-67 – 257 °F]
-----------------------------	---------------------------

Product Compliance

For compliance documentation, visit the product page on TE.com>

EU RoHS Directive 2011/65/EU	Compliant
EU ELV Directive 2000/53/EC	Compliant
China RoHS 2 Directive MIIT Order No 32, 2016	No Restricted Materials Above Threshold
EU REACH Regulation (EC) No. 1907/2006	Current ECHA Candidate List: JUNE 2023 (235) Candidate List Declared Against: JAN 2023 (233) Does not contain REACH SVHC
Halogen Content	Low Halogen - Br, Cl, F, I < 900 ppm per homogenous material. Also BFR/CFR/PVC Free
Solder Process Capability	Not applicable for solder process capability



Product Compliance Disclaimer

This information is provided based on reasonable inquiry of our suppliers and represents our current actual knowledge based on the information they provided. This information is subject to change. The part numbers that TE has identified as EU RoHS compliant have a maximum concentration of 0.1% by weight in homogenous materials for lead, hexavalent chromium, mercury, PBB, PBDE, DBP, BBP, DEHP, DIBP, and 0.01% for cadmium, or qualify for an exemption to these limits as defined in the Annexes of Directive 2011/65/EU (RoHS2). Finished electrical and electronic equipment products will be CE marked as required by Directive 2011/65/EU. Components may not be CE marked. Additionally, the part numbers that TE has identified as EU ELV compliant have a maximum concentration of 0.1% by weight in homogenous materials for lead, hexavalent chromium, and mercury, and 0.01% for cadmium, or qualify for an exemption to these limits as defined in the Annexes of Directive 2000/53/EC (ELV). Regarding the REACH Regulation, the information TE provides on SVHC in articles for this part number is based on the latest European Chemicals Agency (ECHA) 'Guidance on requirements for substances in articles' posted at this URL: <https://echa.europa.eu/guidance-documents/guidance-on-reach>

Compatible Parts



TE Part # CAT-H3910-RC1748
Receptacle Dust Caps — DEUTSCH HD10



TE Part # CAT-H396-RC8382
Receptacle Protective Caps — DEUTSCH HDP20



TE Part # CAT-H3910-PC1748
DEUTSCH HD10 PLUG DUST CAPS

Customers Also Bought



TE Part #HDC16-9-E004
DUST CAP ASM



TE Part #1011-259-0305
BKSHL, 3P, BLK, PLG,ST,SR,NW6/7.5/8.5/10



TE Part #DT06-6S-P012
DEUTSCH DT Plug Connectors



TE Part #1-66741-1
TYPE XII FEMALE CONT (STRIP)



TE Part #HDC14-6
DUST CAP, 6P, PLG, GRY, HD10



TE Part #DTM06-12SB-E003
PLG, 12P, BLK, N, CAP, B



TE Part #2-2350891-2
20POS,HYBRID,PIN HSG ASSY,SLD, COD B



TE Part #CAR2SC68
CAR RECPT DIN9680 2way, IP68

Documents

Product Drawings
RUBBER LANYARD

English

CAD Files



3D PDF

3D

Customer View Model

[ENG_CVM_CVM_JDL082397_99.2d_dxf.zip](#)

English

Customer View Model

[ENG_CVM_CVM_JDL082397_99.3d_igs.zip](#)

English

Customer View Model

[ENG_CVM_CVM_JDL082397_99.3d_stp.zip](#)

English

By downloading the CAD file I accept and agree to the [Terms and Conditions](#) of use.

Datasheets & Catalog Pages

[CONNECTOR SELECTOR](#)

English

Product Specifications

[Application Specification](#)

English