

Aug.1.2023 Copyright 2023 HIROSE ELECTRIC CO., LTD. All Rights Reserved.
In case of consideration for using Automotive equipment / device which demand high reliability, kindly contact our sales window correspondents.

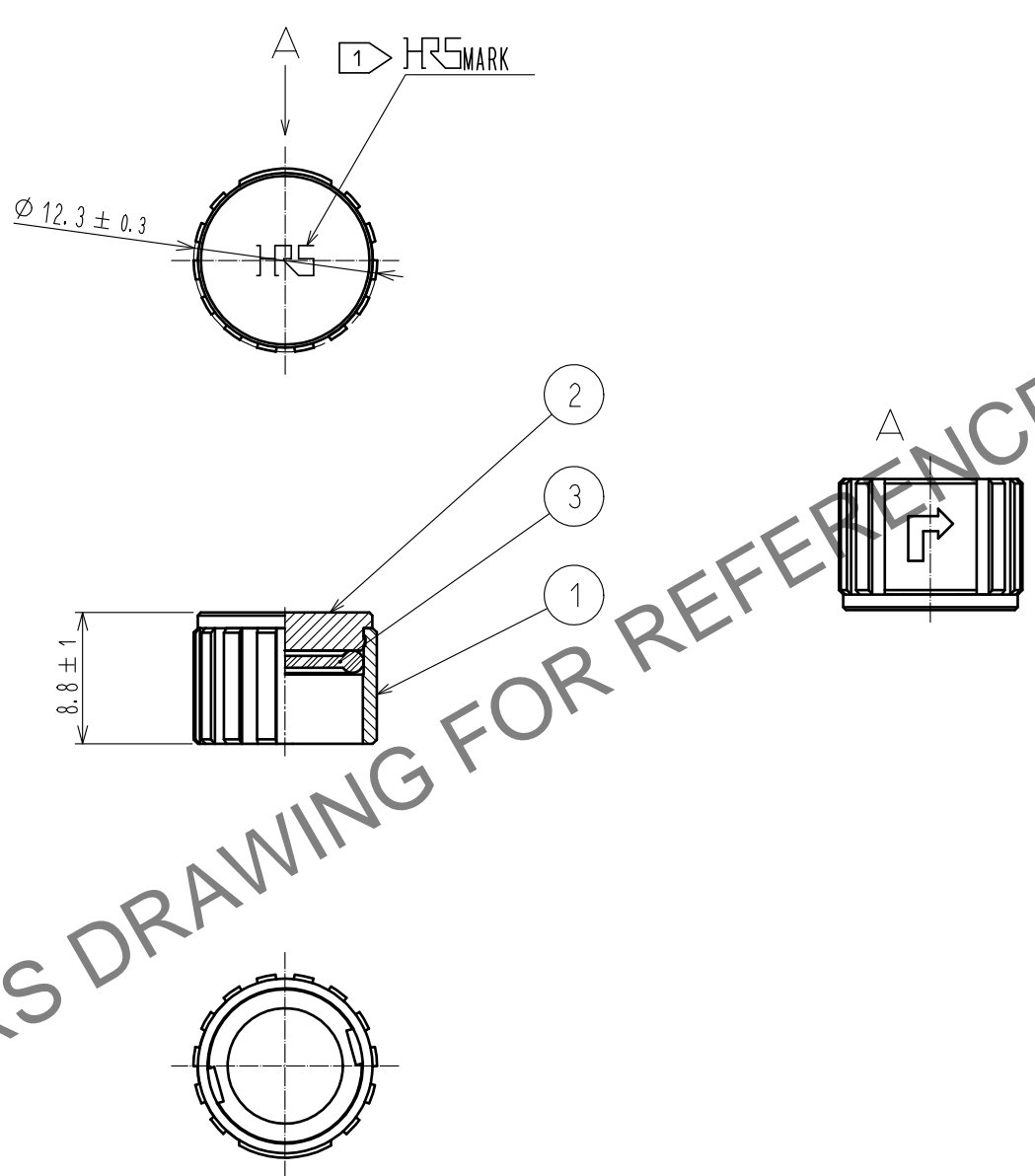

NOTES 1 ROTATION EXAMPLES OF HRS MARK ARE SHOWN.
2 THIS PRODUCT IS A CAP FOR LF07WBR※-※(※).
IT IS APPLICABLE REGARDLESS OF GIVEN ALPHABETS OR NUMBERS SHOWN AT ※.

2	BRASS	NICKEL PLATING			
1	ZINC ALLOY	NICKEL PLATING	3	ACRYLONITRILE BUTADIENE RUBBER (BLACK)	
NO.	MATERIAL	FINISH . REMARKS	NO.	MATERIAL	FINISH . REMARKS
UNITS mm		SCALE 2 : 1	COUNT 	DESCRIPTION OF REVISIONS	DESIGNED
					CHECKED
					DATE
HIROSE ELECTRIC CO., LTD.		APPROVED :HY. KOBAYASHI	18. 02. 22	DRAWING NO.	EDC-118048-31-00
		CHECKED :HY. KOBAYASHI	18. 02. 22	PART NO.	LF07WBR-C(31)
		DESIGNED :TY. SUZUKI	18. 02. 22	CODE NO.	CL136-3008-7-31
		DRAWN :HM. SAITO	18. 02. 20		