

APPROVED: _____
 DATE: _____ TITLE: _____

Rev	AWO #	Description	Date	Appr
-		RELEASED	5/19/08	
A		REVISED SPEC.	10/25/11	
B		REDRAWN	11/01/11	
C		REDRAWN	10/16/15	AY/TW
D		UPDATE SPEC.	11/5/18	AY/RC
E		UPDATE SPEC.	1/27/21	OW/EY
F		UPDATE CHART	8/5/22	SS

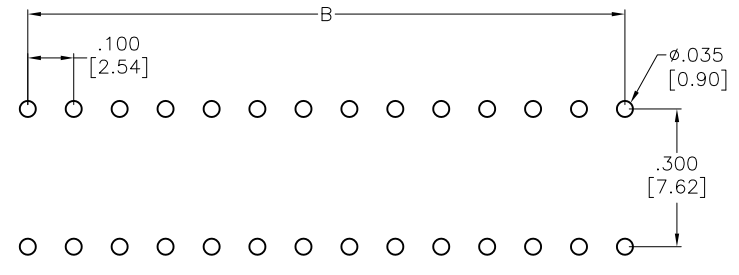

RECOMMENDED PCB LAYOUT

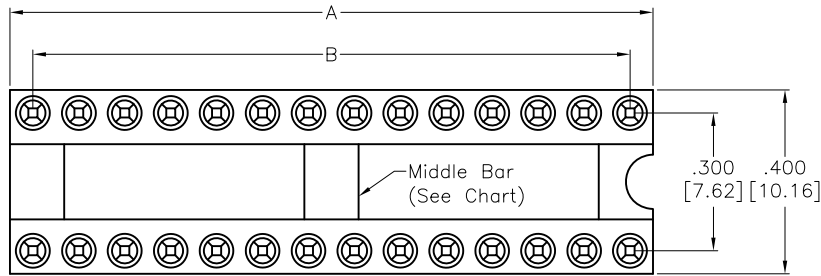
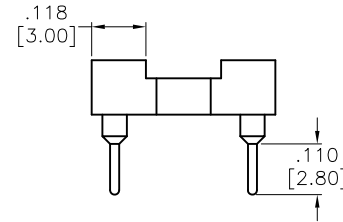
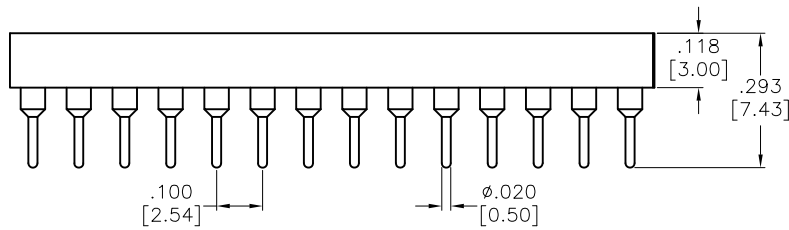

SPECIFICATIONS:
 Material:
 Insulator: (PPS) Hi-Temp Thermoplastic, rated UL 94V-0
 Insulator color: Black
 Pin (Outer Sleeve): Brass
 Clip (Contact 4 finger): Beryllium Copper
 Plating:
 Inner contact: Gold flash over Nickel underplate
 Outer sleeve: Tin over Nickel underplate overall
 Electrical:
 Operating voltage: 60VAC/DC
 Current rating: 3 Amps/contact max.
 Current resistance: $\cong 4\text{m}\Omega$ / contact
 Insulation resistance: $\cong 1,000\text{M}\Omega$ at 100 V
 Mechanical:
 Operating temperature: Gold plated: -55°C to $+105^\circ\text{C}$
 Tin plated: -40°C to $+105^\circ\text{C}$
 Average insertion force: $< 250\text{g}$
 With steel pin of $\varnothing.017$ [0.43mm]
 Average withdrawal force: $> 20\text{g}$ min.
 With steel pin of $\varnothing.017$ [0.43mm]
 Mechanical life: 200 Cycle min.
 Environmental:
 Lead free, RoHS compliant



P/N	POSITION	A	B	MIDDLE BAR
ICM-306-1-GT-HT	6	.300 [7.62]	.200 [5.08]	WITHOUT
ICM-308-1-GT-HT	8	.400 [10.16]	.300 [7.62]	
ICM-310-1-GT-HT	10	.500 [12.70]	.400 [10.16]	
ICM-312-1-GT-HT	12	.600 [15.24]	.500 [12.70]	
ICM-314-1-GT-HT	14	.700 [17.78]	.600 [15.24]	
ICM-316-1-GT-HT	16	.800 [20.32]	.700 [17.78]	
ICM-318-1-GT-HT	18	.900 [22.86]	.800 [20.32]	WITH
ICM-320-1-GT-HT	20	1.000 [25.40]	.900 [22.86]	
ICM-324-1-GT-HT	24	1.200 [30.48]	1.100 [27.94]	
ICM-328-1-GT-HT	28	1.400 [35.56]	1.300 [33.02]	

UNLESS OTHERWISE SPECIFIED
 ALL DIMENSIONS ARE INCHES [MM]
 TOLERANCES: EXCEPT AS NOTED
 INCHES HOLES
 .X $\pm .10$ \varnothing .X $\pm .10$
 .XX $\pm .020$ \varnothing .XX $\pm .015$
 .XXX $\pm .015$ \varnothing .XXX $\pm .010$



909 Rahway Avenue,
 Union, NJ 07083
 Phone: 908-687-5000
 Fax: 908-687-5710

APPROVALS		DATE
DRAWN	SS	5/19/08
CHECKED		
APPROVED		

TITLE SCREW MACHINE IC SOCKET .300" ROW SPACING		
SIZE X	PART NO. ICM-3XX-1-GT-HT	REV. F
REF: S00145C	SCALE: NTS	SHEET 1 OF 1